

ADDITION

# ELEVATION CERTIFICATE

OMB No. 1660-0008  
Expires March 31, 2012

Important: Read the instructions on pages 1-9.

## SECTION A - PROPERTY INFORMATION

A1. Building Owner's Name JOHN RICHARDSON

For Insurance Company Use:

Policy Number

A2. Building Street Address (including Apt., Unit, Suite, and/or Bldg. No.) or P.O. Route and Box No.  
26600 IRON CANYON ROAD

Company NAIC Number

City SANTA CLARITA State CA ZIP Code 91387

A3. Property Description (Lot and Block Numbers, Tax Parcel Number, Legal Description, etc.)  
A PORTION OF THE NORTHEAST QUARTER OF SECTION 36, T4N, R15W, APN 2848-001-019

A4. Building Use (e.g., Residential, Non-Residential, Addition, Accessory, etc.) RESIDENTIAL ADDITION

A5. Latitude/Longitude: Lat. 34-23-22 N Long. 118-24-05 W

Horizontal Datum:  NAD 1927  NAD 1983

A6. Attach at least 2 photographs of the building if the Certificate is being used to obtain flood insurance.

A7. Building Diagram Number 9

A8. For a building with a crawlspace or enclosure(s):

A9. For a building with an attached garage:

a) Square footage of crawlspace or enclosure(s) 2534 sq ft

a) Square footage of attached garage 652 sq ft

b) No. of permanent flood openings in the crawlspace or enclosure(s) within 1.0 foot above adjacent grade 0

b) No. of permanent flood openings in the attached garage within 1.0 foot above adjacent grade 0

c) Total net area of flood openings in A8.b 0 sq in

c) Total net area of flood openings in A9.b 0 sq in

d) Engineered flood openings?  Yes  No

d) Engineered flood openings?  Yes  No

## SECTION B - FLOOD INSURANCE RATE MAP (FIRM) INFORMATION

B1. NFIP Community Name & Community Number  
CITY OF SANTA CLARITA 060729

B2. County Name  
LOS ANGELES

B3. State  
CA

B4. Map/Panel Number  
06037C 0845

B5. Suffix  
F

B6. FIRM Index Date  
09.26.08

B7. FIRM Panel Effective/Revised Date  
09.26.08

B8. Flood Zone(s)  
A

B9. Base Flood Elevation(s) (Zone AO, use base flood depth)  
1891.91

B10. Indicate the source of the Base Flood Elevation (BFE) data or base flood depth entered in Item B9.

FIS Profile  FIRM  Community Determined  Other (Describe) QUICK-2

B11. Indicate elevation datum used for BFE in Item B9:  NGVD 1929  NAVD 1988  Other (Describe) \_\_\_\_\_

B12. Is the building located in a Coastal Barrier Resources System (CBRS) area or Otherwise Protected Area (OPA)?  Yes  No  
Designation Date \_\_\_\_\_  CBRS  OPA

## SECTION C - BUILDING ELEVATION INFORMATION (SURVEY REQUIRED)

C1. Building elevations are based on:  Construction Drawings\*  Building Under Construction\*  Finished Construction

\*A new Elevation Certificate will be required when construction of the building is complete.

C2. Elevations - Zones A1-A30, AE, AH, A (with BFE), VE, V1-V30, V (with BFE), AR, AR/A, AR/AE, AR/A1-A30, AR/AH, AR/AO. Complete Items C2.a-h below according to the building diagram specified in Item A7. Use the same datum as the BFE.

Benchmark Utilized LA COUNTY BM #L5248 Vertical Datum NAVD 1988

Conversion/Comments LA COUNTY BM #L5248, EL: 1721.607, NEWHALL QUAD, 2003 ADJUSTMENT

Check the measurement used.

- a) Top of bottom floor (including basement, crawlspace, or enclosure floor) 1890.08  feet  meters (Puerto Rico only)
- b) Top of the next higher floor 1893.23  feet  meters (Puerto Rico only)
- c) Bottom of the lowest horizontal structural member (V Zones only) NA  feet  meters (Puerto Rico only)
- d) Attached garage (top of slab) 1891.13  feet  meters (Puerto Rico only)
- e) Lowest elevation of machinery or equipment servicing the building (Describe type of equipment and location in Comments) 1890.98  feet  meters (Puerto Rico only)
- f) Lowest adjacent (finished) grade next to building (LAG) 1890.25  feet  meters (Puerto Rico only)
- g) Highest adjacent (finished) grade next to building (HAG) 1891.33  feet  meters (Puerto Rico only)
- h) Lowest adjacent grade at lowest elevation of deck or stairs, including structural support NA  feet  meters (Puerto Rico only)

## SECTION D - SURVEYOR, ENGINEER, OR ARCHITECT CERTIFICATION

This certification is to be signed and sealed by a land surveyor, engineer, or architect authorized by law to certify elevation information. I certify that the information on this Certificate represents my best efforts to interpret the data available. I understand that any false statement may be punishable by fine or imprisonment under 18 U.S. Code, Section 1001.

Check here if comments are provided on back of form. Were latitude and longitude in Section A provided by a licensed land surveyor?  Yes  No

Certifier's Name RONALD KOESTER

License Number LS 5930

Title PRESIDENT

Company Name CRC ENTERPRISES

Address 27600 BOUQUET CANYON ROAD, #200

City SANTA CLARITA, CA

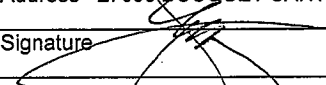
Signature 

Date 09.14.10

Telephone 661-297-2336

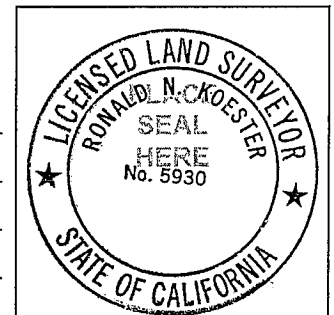

<b>IMPORTANT: In these spaces, copy the corresponding information from Section A.</b>	For Insurance Company Use:
Building Street Address (including Apt., Unit, Suite, and/or Bldg. No.) or P.O. Route and Box No. 26600 IRON CANYON ROAD	Policy Number
City SANTA CLARITA State CA ZIP Code 91387	Company NAIC Number

**SECTION D - SURVEYOR, ENGINEER, OR ARCHITECT CERTIFICATION (CONTINUED)**

Copy both sides of this Elevation Certificate for (1) community official, (2) insurance agent/company, and (3) building owner.

Comments PURPOSE IS TO CERTIFY FINISHED CONSTRUCTION FOR 261 SQUARE FOOT RESIDENTIAL ADDITION. NEXT HIGHER FLOOR LISTED IN C2-B IS FINISHED FLOOR OF THE ADDITION ONLY AND NOT THE SAME NEXT HIGHER FLOOR AS THE ENTIRE HOUSE. ORIGINAL STRUCTURE PERMITTED UNDER COUNTY PRIOR TO CITY INCORPORATION. COUNTY DID NOT VERIFY UTILITY REQUIREMENT. CONDITION EXISTED PRIOR TO CITY JURISDICTION.

Signature  Date 09.14.10  Check here if attachments

**SECTION E - BUILDING ELEVATION INFORMATION (SURVEY NOT REQUIRED) FOR ZONE AO AND ZONE A (WITHOUT BFE)**

For Zones AO and A (without BFE), complete Items E1-E5. If the Certificate is intended to support a LOMA or LOMR-F request, complete Sections A, B, and C. For Items E1-E4, use natural grade, if available. Check the measurement used. In Puerto Rico only, enter meters.

- E1. Provide elevation information for the following and check the appropriate boxes to show whether the elevation is above or below the highest adjacent grade (HAG) and the lowest adjacent grade (LAG).
  - a) Top of bottom floor (including basement, crawlspace, or enclosure) is \_\_\_\_\_  feet  meters  above or  below the HAG.
  - b) Top of bottom floor (including basement, crawlspace, or enclosure) is \_\_\_\_\_  feet  meters  above or  below the LAG.
- E2. For Building Diagrams 6-9 with permanent flood openings provided in Section A Items 8 and/or 9 (see pages 8-9 of Instructions), the next higher floor (elevation C2.b in the diagrams) of the building is \_\_\_\_\_  feet  meters  above or  below the HAG.
- E3. Attached garage (top of slab) is \_\_\_\_\_  feet  meters  above or  below the HAG.
- E4. Top of platform of machinery and/or equipment servicing the building is \_\_\_\_\_  feet  meters  above or  below the HAG.
- E5. Zone AO only: If no flood depth number is available, is the top of the bottom floor elevated in accordance with the community's floodplain management ordinance?  Yes  No  Unknown. The local official must certify this information in Section G.

**SECTION F - PROPERTY OWNER (OR OWNER'S REPRESENTATIVE) CERTIFICATION**

The property owner or owner's authorized representative who completes Sections A, B, and E for Zone A (without a FEMA-issued or community-issued BFE) or Zone AO must sign here. *The statements in Sections A, B, and E are correct to the best of my knowledge.*

Property Owner's or Owner's Authorized Representative's Name \_\_\_\_\_

Address \_\_\_\_\_ City \_\_\_\_\_ State \_\_\_\_\_ ZIP Code \_\_\_\_\_

Signature \_\_\_\_\_ Date \_\_\_\_\_ Telephone \_\_\_\_\_

Comments \_\_\_\_\_

Check here if attachments

**SECTION G - COMMUNITY INFORMATION (OPTIONAL)**

The local official who is authorized by law or ordinance to administer the community's floodplain management ordinance can complete Sections A, B, C (or E), and G of this Elevation Certificate. Complete the applicable item(s) and sign below. Check the measurement used in Items G8 and G9.

- G1.  The information in Section C was taken from other documentation that has been signed and sealed by a licensed surveyor, engineer, or architect who is authorized by law to certify elevation information. (Indicate the source and date of the elevation data in the Comments area below.)
- G2.  A community official completed Section E for a building located in Zone A (without a FEMA-issued or community-issued BFE) or Zone AO.
- G3.  The following information (Items G4-G9) is provided for community floodplain management purposes.

G4. Permit Number	G5. Date Permit Issued	G6. Date Certificate Of Compliance/Occupancy Issued
-------------------	------------------------	---

- G7. This permit has been issued for:  New Construction  Substantial Improvement
- G8. Elevation of as-built lowest floor (including basement) of the building: \_\_\_\_\_  feet  meters (PR) Datum \_\_\_\_\_
- G9. BFE or (in Zone AO) depth of flooding at the building site: \_\_\_\_\_  feet  meters (PR) Datum \_\_\_\_\_
- G10. Community's design flood elevation \_\_\_\_\_  feet  meters (PR) Datum \_\_\_\_\_

Local Official's Name \_\_\_\_\_ Title \_\_\_\_\_

Community Name \_\_\_\_\_ Telephone \_\_\_\_\_

Signature \_\_\_\_\_ Date \_\_\_\_\_

Comments \_\_\_\_\_

Check here if attachments