

ELEVATION CERTIFICATE

Important: Read the instructions on pages 1-9.

SECTION A - PROPERTY INFORMATION

A1. Building Owner's Name <u>Shuki Levi</u>		For Insurance Company Use
		Policy Number
A2. Building Street Address (including Apt., Unit, Suite, and/or Bldg. No.) or P.O. Route and Box No. <u>26933 Sand Canyon Road, MAIN HOUSE</u>		Company NAIC Number
City <u>Santa Clarita</u> State <u>CA</u> ZIP Code <u>91387</u>		
A3. Property Description (Lot and Block Numbers, Tax Parcel Number, Legal Description, etc.) A.P.N. <u>2841-018-063</u> : Portions of Parcel 3 and 4 of Parcel Map No. 7909 BK. 95 PG. 18		
A4. Building Use (e.g., Residential, Non-Residential, Addition, Accessory, etc.) <u>New Single Family Residential Guest House</u>		
A5. Latitude/Longitude: Lat. <u>34°23'51" N</u> Long. <u>118°24'59" W</u>		Horizontal Datum: <input type="checkbox"/> NAD 1927 <input checked="" type="checkbox"/> NAD 1983
A6. Attach at least 2 photographs of the building if the Certificate is being used to obtain flood insurance.		
A7. Building Diagram Number <u>8</u>		
A8. For a building with a crawlspace or enclosure(s):		A9. For a building with an attached garage:
a) Square footage of crawlspace or enclosure(s) <u>3,306</u> sq ft		a) Square footage of attached garage <u>460</u> sq ft
b) No. of permanent flood openings in the crawlspace or enclosure(s) within 1.0 foot above adjacent grade <u>22</u>		b) No. of permanent flood openings in the attached garage within 1.0 foot above adjacent grade <u>5</u>
c) Total net area of flood openings in A8.b <u>4,896</u> sq in		c) Total net area of flood openings in A9.b <u>605</u> sq in
d) Engineered flood openings? <input type="checkbox"/> Yes <input checked="" type="checkbox"/> No		d) Engineered flood openings? <input type="checkbox"/> Yes <input checked="" type="checkbox"/> No

SECTION B - FLOOD INSURANCE RATE MAP (FIRM) INFORMATION

B1. NFIP Community Name & Community Number <u>City of Santa Clarita 060729</u>		B2. County Name <u>Los Angeles</u>	B3. State <u>California</u>	
B4. Map/Panel Number <u>060719 0480</u>	B5. Suffix <u>C</u>	B6. FIRM Index Date <u>Sept. 29, 1989</u>	B7. FIRM Panel Effective/Revised Date <u>Sept. 29, 1989</u>	B8. Flood Zone(s) <u>AO</u>
B9. Base Flood Elevation(s) (Zone AO, use base flood depth) <u>3'</u>				
B10. Indicate the source of the Base Flood Elevation (BFE) data or base flood depth entered in Item B9. <input type="checkbox"/> FIS Profile <input checked="" type="checkbox"/> FIRM <input type="checkbox"/> Community Determined <input type="checkbox"/> Other (Describe) _____				
B11. Indicate elevation datum used for BFE in Item B9: <input checked="" type="checkbox"/> NGVD 1929 <input type="checkbox"/> NAVD 1988 <input type="checkbox"/> Other (Describe) _____				
B12. Is the building located in a Coastal Barrier Resources System (CBRS) area or Otherwise Protected Area (OPA)? <input type="checkbox"/> Yes <input checked="" type="checkbox"/> No Designation Date _____ <input type="checkbox"/> CBRS <input type="checkbox"/> OPA				

SECTION C - BUILDING ELEVATION INFORMATION (SURVEY REQUIRED)

C1. Building elevations are based on: Construction Drawings* Building Under Construction* Finished Construction
*A new Elevation Certificate will be required when construction of the building is complete.

C2. Elevations - Zones A1-A30, AE, AH, A (with BFE), VE, V1-V30, V (with BFE), AR, AR/A, AR/AE, AR/A1-A30, AR/AH, AR/AO. Complete Items C2.a-h below according to the building diagram specified in Item A7. Use the same datum as the BFE.

Benchmark Utilized _____ Vertical Datum _____
Conversion/Comments _____

Check the measurement used.

a) Top of bottom floor (including basement, crawlspace, or enclosure floor) _____	<input type="checkbox"/> feet	<input type="checkbox"/> meters (Puerto Rico only)
b) Top of the next higher floor _____	<input type="checkbox"/> feet	<input type="checkbox"/> meters (Puerto Rico only)
c) Bottom of the lowest horizontal structural member (V Zones only) _____	<input type="checkbox"/> feet	<input type="checkbox"/> meters (Puerto Rico only)
d) Attached garage (top of slab) _____	<input type="checkbox"/> feet	<input type="checkbox"/> meters (Puerto Rico only)
e) Lowest elevation of machinery or equipment servicing the building (Describe type of equipment and location in Comments) _____	<input type="checkbox"/> feet	<input type="checkbox"/> meters (Puerto Rico only)
f) Lowest adjacent (finished) grade next to building (LAG) _____	<input type="checkbox"/> feet	<input type="checkbox"/> meters (Puerto Rico only)
g) Highest adjacent (finished) grade next to building (HAG) _____	<input type="checkbox"/> feet	<input type="checkbox"/> meters (Puerto Rico only)
h) Lowest adjacent grade at lowest elevation of deck or stairs, including structural support _____	<input type="checkbox"/> feet	<input type="checkbox"/> meters (Puerto Rico only)

SECTION D - SURVEYOR, ENGINEER, OR ARCHITECT CERTIFICATION

This certification is to be signed and sealed by a land surveyor, engineer, or architect authorized by law to certify elevation information. I certify that the information on this Certificate represents my best efforts to interpret the data available. I understand that any false statement may be punishable by fine or imprisonment under 18 U.S. Code, Section 1001.

Check here if comments are provided on back of form. Were latitude and longitude in Section A provided by a licensed land surveyor? Yes No

Certifier's Name	License Number		
Title	Company Name		
Address	City	State	ZIP Code
Signature	Date	Telephone	

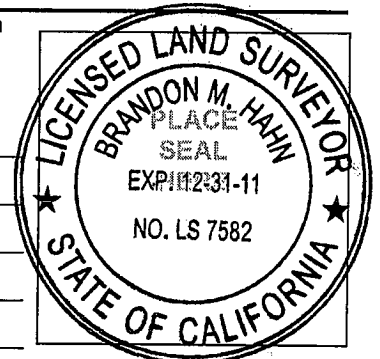

IMPORTANT: In these spaces, copy the corresponding information from Section A.	For Insurance Company Use:
Building Street Address (including Apt., Unit, Suite, and/or Bldg. No.) or P.O. Route and Box No. 26933 Sand Canyon Road, Guest House	Policy Number
City Santa Clarita State CA ZIP Code 91387	Company NAIC Number

SECTION D - SURVEYOR, ENGINEER, OR ARCHITECT CERTIFICATION (CONTINUED)

Copy both sides of this Elevation Certificate for (1) community official, (2) insurance agent/company, and (3) building owner.

Comments The lowest level of machinery or equipment is 1707.5', being the bottom of electrical wires below the electrical panel in the enclosed attached utility building. Also, the a/c compressor's are located on the roof and the water heater is located inside of the house.

Brandon M. Hahn

Signature	Date 06-30-2010	<input type="checkbox"/> Check here if attachments
-----------	-----------------	--

SECTION E - BUILDING ELEVATION INFORMATION (SURVEY NOT REQUIRED) FOR ZONE AO AND ZONE A (WITHOUT BFE)

For Zones AO and A (without BFE), complete Items E1-E5. If the Certificate is intended to support a LOMA or LOMR-F request, complete Sections A, B, and C. For Items E1-E4, use natural grade, if available. Check the measurement used. In Puerto Rico only, enter meters.

- E1. Provide elevation information for the following and check the appropriate boxes to show whether the elevation is above or below the highest adjacent grade (HAG) and the lowest adjacent grade (LAG).
- a) Top of bottom floor (including basement, crawlspace, or enclosure) is 4.8 feet meters above or below the HAG.
- b) Top of bottom floor (including basement, crawlspace, or enclosure) is 7.0 feet meters above or below the LAG.
- E2. For Building Diagrams 6-9 with permanent flood openings provided in Section A Items 8 and/or 9 (see pages 8-9 of Instructions), the next higher floor (elevation C2.b in the diagrams) of the building is 15.9 feet meters above or below the HAG.
- E3. Attached garage (top of slab) is 0.2 feet meters above or below the HAG.
- E4. Top of platform of machinery and/or equipment servicing the building is 4.0 feet meters above or below the HAG.
- E5. Zone AO only: If no flood depth number is available, is the top of the bottom floor elevated in accordance with the community's floodplain management ordinance? Yes No Unknown. The local official must certify this information in Section G.

SECTION F - PROPERTY OWNER (OR OWNER'S REPRESENTATIVE) CERTIFICATION

The property owner or owner's authorized representative who completes Sections A, B, and E for Zone A (without a FEMA-issued or community-issued BFE) or Zone AO must sign here. *The statements in Sections A, B, and E are correct to the best of my knowledge.*

Property Owner's or Owner's Authorized Representative's Name Brandon M. Hahn			
Address 26074 Ave. Hall, Suite No. 2	City Santa Clarita	State CA	ZIP Code 91355
Signature <i>Brandon M. Hahn</i>	Date 06-30-2010	Telephone (661) 775-9500	

Comments

Check here if attachments

SECTION G - COMMUNITY INFORMATION (OPTIONAL)

The local official who is authorized by law or ordinance to administer the community's floodplain management ordinance can complete Sections A, B, C (or E), and G of this Elevation Certificate. Complete the applicable item(s) and sign below. Check the measurement used in Items G8 and G9.

- G1. The information in Section C was taken from other documentation that has been signed and sealed by a licensed surveyor, engineer, or architect who is authorized by law to certify elevation information. (Indicate the source and date of the elevation data in the Comments area below.)
- G2. A community official completed Section E for a building located in Zone A (without a FEMA-issued or community-issued BFE) or Zone AO.
- G3. The following information (Items G4-G9) is provided for community floodplain management purposes.

G4. Permit Number	G5. Date Permit Issued	G6. Date Certificate Of Compliance/Occupancy Issued
-------------------	------------------------	---

- G7. This permit has been issued for: New Construction Substantial Improvement
- G8. Elevation of as-built lowest floor (including basement) of the building: _____ feet meters (PR) Datum _____
- G9. BFE or (in Zone AO) depth of flooding at the building site: _____ feet meters (PR) Datum _____
- G10. Community's design flood elevation _____ feet meters (PR) Datum _____

Local Official's Name	Title
Community Name	Telephone
Signature	Date
Comments	

Check here if attachments