

PARCEL MAP/TRACT NO. XXXXX ADDRESS FOR SINGLE LOT, PC NO. 20-XX SHEETS: PAGES CITY OF SANTA CLARITA CSMD INDEX

SANTA CLARITA VALLEY SANITATION DISTRICT OF LOS ANGELES COUNTY, CALIFORNIA ROBERT C. FERRANTE - CHIEF ENGINEER and GENERAL MANAGER

APPROVED BY OFFICE ENGINEER DATE: NEWHALL COUNTY WATER DISTRICT APPROVED BY OFFICE ENGINEER DATE: COUNTY OF LOS ANGELES DEPARTMENT OF PUBLIC WORKS CONSOLIDATED SEWER MAINTENANCE DISTRICT REVIEWED FOR MAINTENANCE REVIEWED BY OFFICE ENGINEER DATE:

CITY OF SANTA CLARITA APPROVED FOR CONSTRUCTION MIKE HENNAWY CITY ENGINEER DATE OF EXECUTION PLAN CHECKER DATE OF EXECUTION

IN ACCORDANCE WITH RESOLUTION No. 19-6, AS A RESOLUTION OF THE CITY COUNCIL OF THE CITY OF SANTA CLARITA DELEGATING DISCRETIONARY AUTHORITY TO THE DIRECTOR OF PUBLIC WORKS...

Table with 7 columns: NO., REVISION, REVISED BY, SMD APPROVAL, DATE, CITY APPROVAL, EXECUTION DATE.

NO CITY CHARGES/NO LA COUNTY CHARGES FOR CONNECTION SEE COUNTY SANITATION DISTRICT FOR SPECIAL CONNECTION CHARGES TEL: (602) 908-4288 EX. 2727 SCALE: VERT. 1" = 4' HORIZ. 1" = 40' DOUBLE SCALE (when applicable)

REVIEWED BY DATE

PRIVATE CONTRACT SEWER GENERAL NOTES:

- 1. A SEWER CONSTRUCTION PERMIT SHALL BE OBTAINED AND A FEE PAID FOR CONSTRUCTION INSPECTION AND RECORD PLANS TO THE CITY OF SANTA CLARITA... 2. THE CONTRACTOR SHALL NOTIFY THE CITY OF SANTA CLARITA PUBLIC WORKS INSPECTION BY PHONE AT (661) 255-4942 AT LEAST 24 HOURS PRIOR TO START OF WORK...

CONSTRUCTION NOTES:

- 1. CONTRACTOR SHALL PROVIDE SURVEY STAKES ON THE PROPERTY LINE OR PROPERTY LINES PRODUCED AT RIGHT ANGLES TO THE SEWER LINE AT THE CENTERLINE OF EACH MANHOLE... 2. VITRIFIED CLAY PIPE JOINTS SHALL BE TYPE "D" OR "C" IN ACCORDANCE WITH "STANDARD SPECIFICATIONS FOR PUBLIC WORKS CONSTRUCTION" SECTION 208-2...

STORMWATER POLLUTION PLAN NOTES:

- 1. EVERY EFFORT SHOULD BE MADE TO ELIMINATE THE DISCHARGE OF NON-STORMWATER FROM THE PROJECT SITE AT ALL TIMES... 2. ERODED SEDIMENTS AND OTHER POLLUTANTS MUST BE RETAINED ON-SITE AND MAY NOT BE TRANSPORTED FROM THE SITE VIA SHEET FLOW, SWALES, AREA DRAINS, NATURAL DRAINAGE COURSES OR WIND...

Table with 3 columns: EROSION CONTROL, NON-STORM WATER MANAGEMENT, WASTE MANAGEMENT AND MATERIALS POLLUTION CONTROL. Lists various control measures like scheduling, mulch, seeding, etc.

B. STANDARD PLANS:

Table listing standard plans for construction, such as 2000-0 LEGEND FOR SANITARY SEWER PLANS AND PROFILES AND 2021-1 BEDDING FOR SEWER PIPE.

COUNTY SANITATION DISTRICT (CSD) NOTES:

- 1. NO CONNECTION FOR THE DISPOSAL OF INDUSTRIAL WASTES SHALL BE MADE TO SEWERS SHOWN ON THESE DRAWINGS UNTIL A PERMIT FOR INDUSTRIAL WASTE WATER DISCHARGE HAS BEEN ISSUED BY THE COUNTY SANITATION DISTRICTS FOR SAID CONNECTIONS... 2. PRIOR TO FINAL ACCEPTANCE OF THE PROJECT, NOTIFY THE CSD SUPERINTENDENT OF MAINTENANCE AT (310) 638-1161 TO REPORT COMPLETION OF CONSTRUCTION OF THIS LOCAL SEWER THAT INDIRECTLY CONNECTS TO THE CSD SEWER SYSTEM...

BENCH MARKS BM XXXXXXXXXXXX Elev. QUAD 20XX

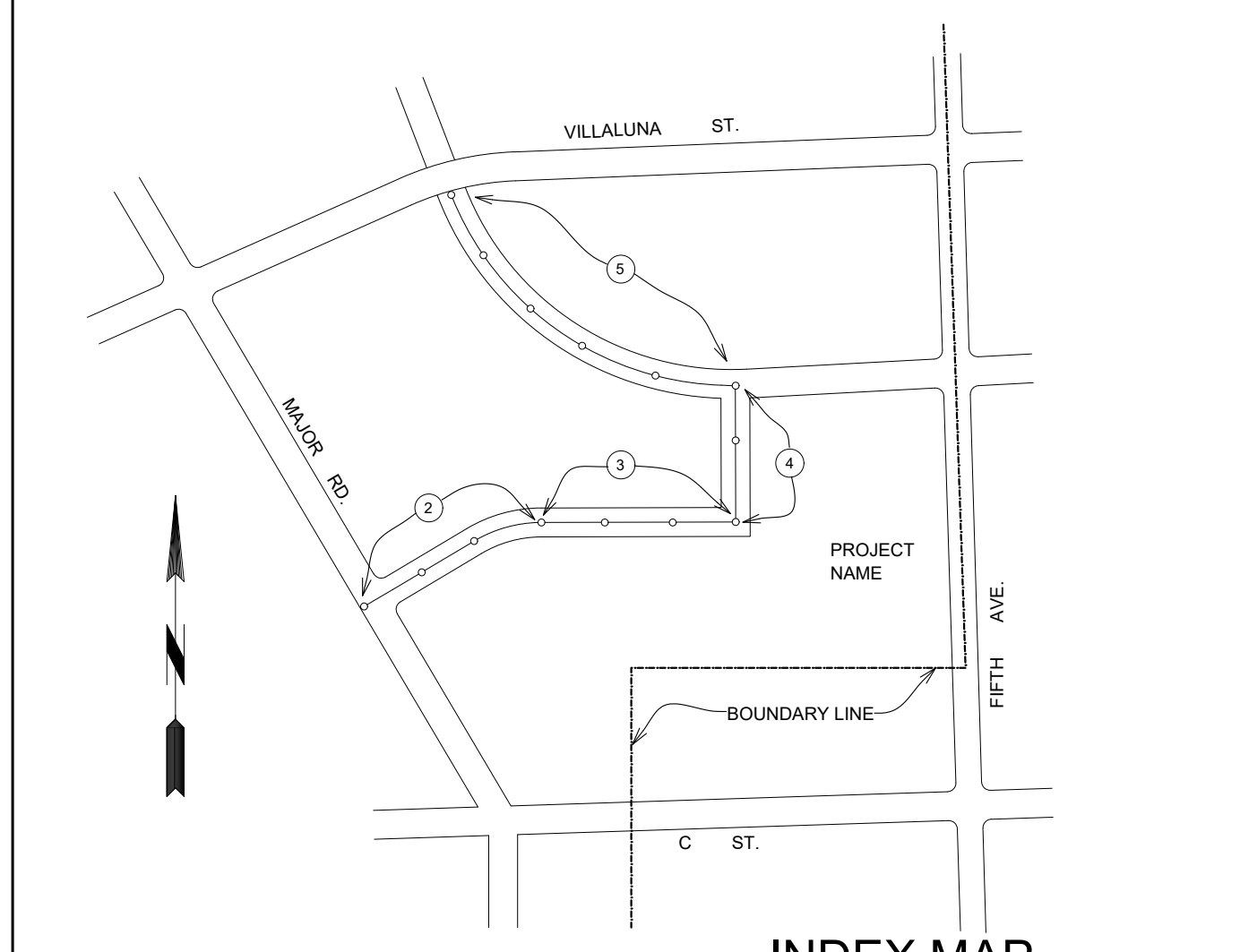

INDEX MAP SCALE: 1" = 200' or 300' CSMD INDEX NOTES: NUMBER IN CIRCLE INDICATES PAGE NUMBER. ALL MAINLINE SANITARY SEWERS ARE WITHIN THE SANITARY SEWER EASEMENT (IF APPLICABLE).

PRIVATE ENGINEERS NOTICE TO CONTRACTORS: THE EXISTENCE AND LOCATION OF ANY UNDERGROUND UTILITY PIPES OR STRUCTURES SHOWN ON THESE PLANS IS REQUIRED BY A SEARCH OF AVAILABLE RECORDS TO THE BEST OF OUR KNOWLEDGE...

PROJECT ENGINEER RCE NO DATE

Main grid area for construction details, including notes on manhole construction and standards.

BASIS OF BEARING

- RECONSTRUCTION NOTES: 1. Remove existing sewer pipes and install new sewer as noted above. 2. Break into existing manhole and form new channel in base per SPPWC 208-2. 3. Maintain sewer flow at all times during construction. 4. Remodel and reconnect all existing house laterals per LA County standards.

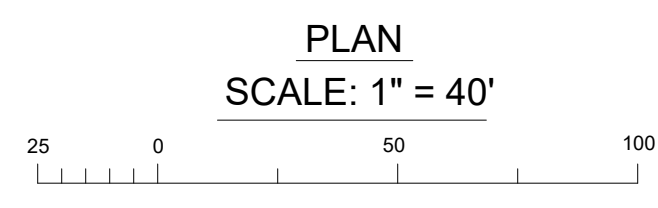

COMPANY NAME & ADDRESS TELEPHONE NUMBER & E-MAIL

PROJECT ENGINEER DATE DWG