



# CITY OF SANTA CLARITA

BUILDING & SAFETY DIVISION  
23920 Valencia Boulevard, Suite 140  
Santa Clarita, CA 91355 (661) 255-4935

# Residential Electrical Transfer Switch

(NON-STRUCTURAL, NO CHANGE OF USE)

THIS PLAN IS AN EXAMPLE ONLY. DEPENDING ON THE NATURE OF YOUR PROJECT, BUILDING & SAFETY MAY REQUIRE ADDITIONAL PLANS AND/OR CALCULATIONS TO DEMONSTRATE CODE COMPLIANCE.

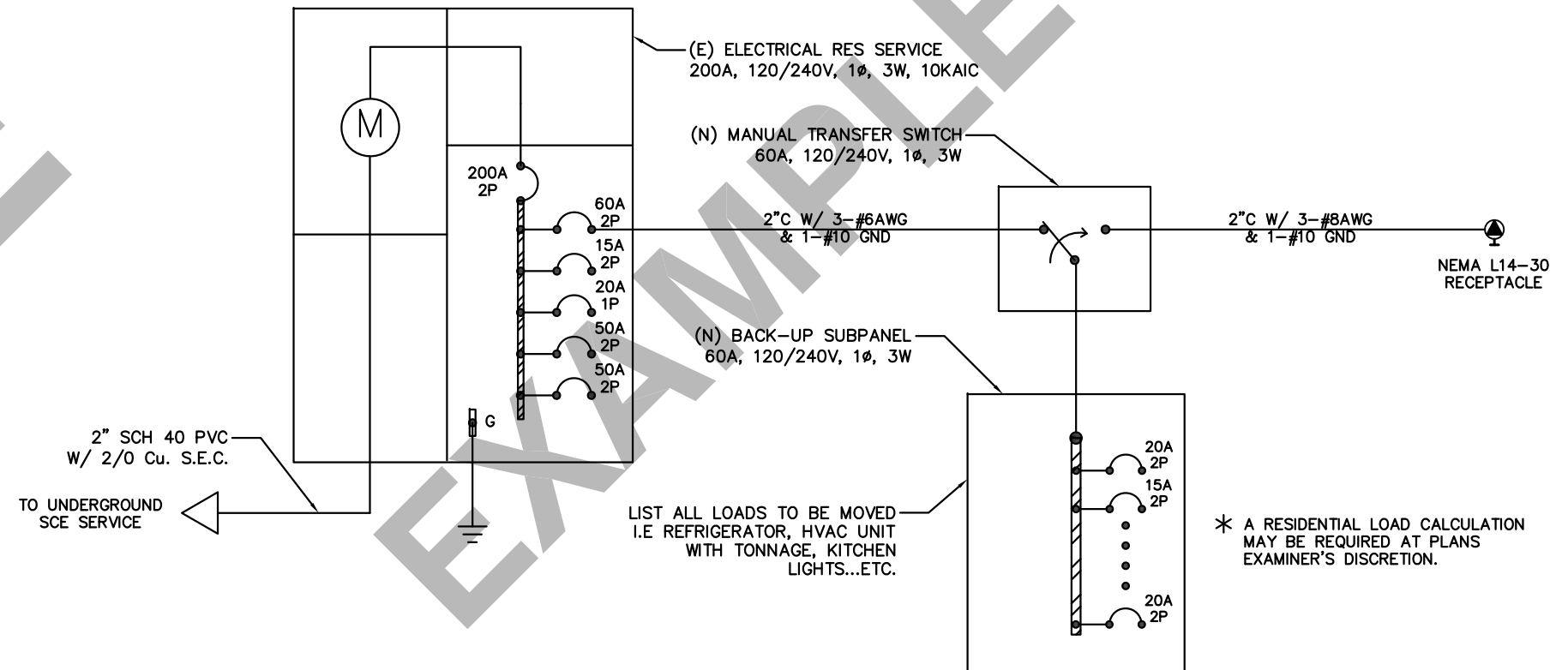
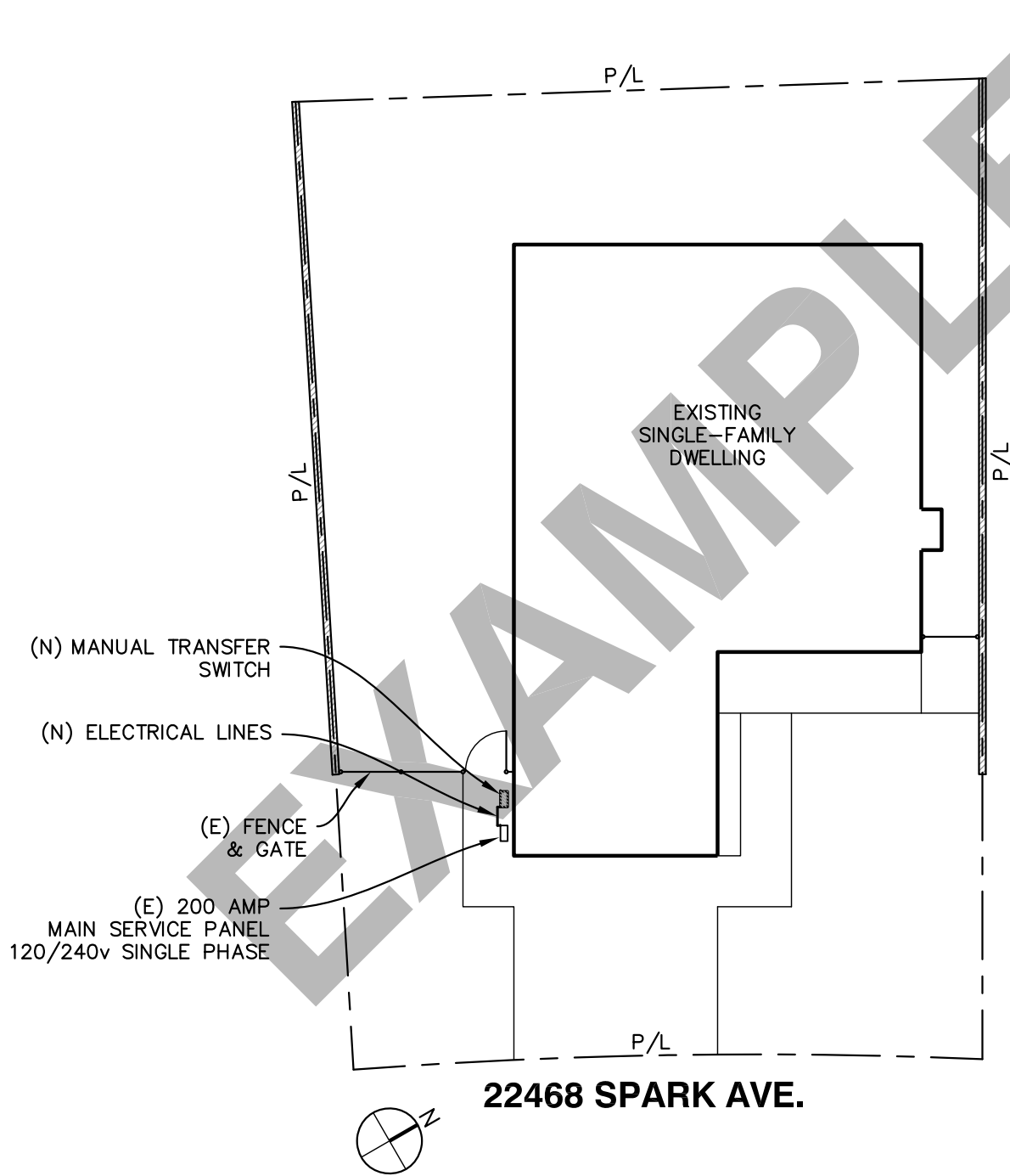

### GENERAL NOTES

CONSTRUCTION NOTES FOR NEW TRANSFER SWITCH AND ELECTRICAL SCOPE SHALL INCLUDE THE FOLLOWING:

- MATERIAL SPECIFICATIONS.
- ALL MAKE/MODEL OF NEW EQUIPMENT.
- PROVIDE MANUFACTURER DOCUMENTATION FOR GENERATORS, PV... AND OTHER ALTERNATE POWER PRODUCTION SOURCES DEMONSTRATING COMPATIBILITY WITH ONE ANOTHER, OTHERWISE PROVIDE A MEANS TO ISOLATE THE ALTERNATE POWER SOURCES FROM EACH OTHER.

PLANS SHALL BE PREPARED BY A CALIFORNIA LICENSED ELECTRICAL ENGINEER OR BY THE CALIFORNIA LICENSED CONTRACTOR WHO WILL PERFORM THE WORK.

THE PLANS SHALL INCLUDE THE NAME, CONTACT INFORMATION AND SIGNATURE OF THE PERSON WHO PREPARED THEM ON EACH SHEET OF THE PLANS.

### BASIC SITE PLAN REQUIREMENTS

- PLANS SHALL BE DRAWN ON SUBSTANTIAL PAPER (8.5"x11" OR LARGER).
- MINIMUM SCALE SHALL BE 1" = 20'.
- TEXT SHALL BE LEGIBLE.
- PLAN SHEETS SHALL BE NUMBERED.
- EACH SHEET OF THE PLANS SHALL INCLUDE THE PROJECT ADDRESS.
- LABEL ALL SCOPE OF WORK AS NEW (N) OR EXISTING (E).
- APPROVALS FROM OTHER CITY DIVISIONS AND OUTSIDE AGENCIES MAY BE REQUIRED PRIOR TO BUILDING PERMIT ISSUANCE.

### SITE CONDITIONS

THE FOLLOWING SITE CONDITIONS MAY AFFECT YOUR PROJECT. SHOW THESE ITEMS ON THE SITE PLAN (WHEN APPLICABLE):

- FIRE ZONE
- FLOOD ZONE
- OAK TREES
- EASEMENTS
- OPENINGS INTO THE DWELLING

### HOW TO OBTAIN INFORMATION ABOUT YOUR PROPERTY

PROPERTY MAPS AND DATA ARE AVAILABLE AT THE L.A. COUNTY ASSESSOR'S WEBSITE:  
HTTP://ASSESSOR.LACOUNTY.GOV

SITE CONDITIONS CAN BE IDENTIFIED BY USING THE CITY'S GEOGRAPHIC INFORMATION SYSTEM (GIS) WEBSITE:  
WWW.SANTA-CLARITA.COM/GIS