

Project Location:
Golden Valley Road
and SR-14 Interchange.

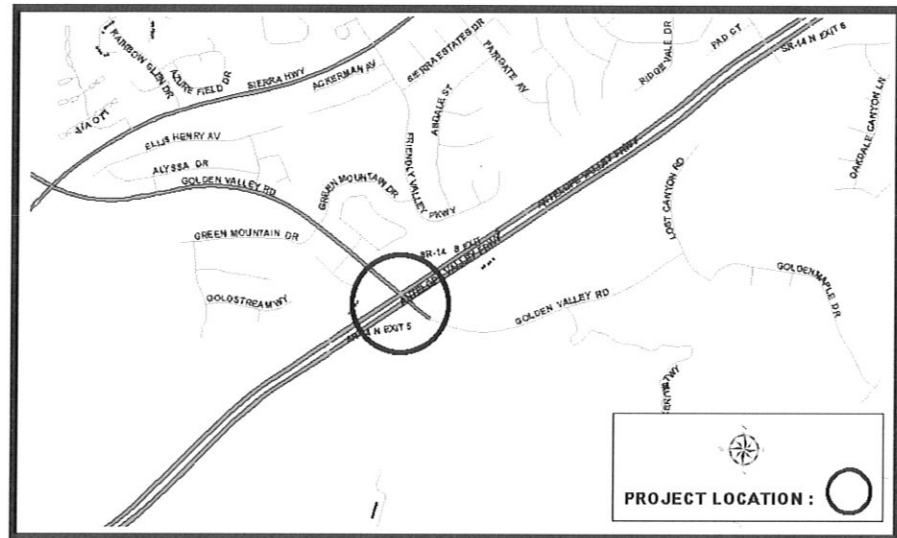

Description: Project will widen the bridge from the existing one lane in each direction to six total lanes. Multi-modal amenities include the construction of a sidewalk on the north side of the bridge, and a shared sidewalk and bike path on the south side. It will also make modifications to on -and off-ramps, and add landscaped medians.

Justification: These improvements have been identified in the EastSide Bridge and Thoroughfare District Report as necessary to accommodate anticipated increases to traffic volumes based on future development.

Project Status: In progress.

Department: Public Works

Project Supervisor: Curtis Nay

Project Cost Est. (\$):

<u>Expenditure/Category:</u>	<u>PriorYears</u>	<u>2012-13</u>	<u>2013-14</u>	<u>2014-15</u>	<u>2015-16</u>	<u>2016-17</u>	<u>Total</u>
Environ/NPDES	0	3,000	0	0	0	0	3,000
Design/Plan Review	700,000	0	0	0	0	0	700,000
Right-of-Way	0	0	0	0	0	0	0
Construction	0	5,225,898	0	0	0	0	5,225,898
Inspection & Admin	44,294	1,200,000	0	0	0	0	1,244,294
Contingency	0	2,100,000	0	0	0	0	2,100,000
Total Costs:	\$744,294	\$8,528,898	\$0	\$0	\$0	\$0	\$9,273,192

Project Funding:

<u>Funding Source:</u>	<u>PriorYears</u>	<u>2012-13</u>	<u>2013-14</u>	<u>2014-15</u>	<u>2015-16</u>	<u>2016-17</u>	<u>Total</u>
B&T East Side	744,294	4,114,449	0	0	0	0	4,858,743
LMD 2008-1	0	150,000	0	0	0	0	150,000
Prop. C Grant	0	4,264,449	0	0	0	0	4,264,449
	0	0	0	0	0	0	0
	0	0	0	0	0	0	0
	0	0	0	0	0	0	0
	0	0	0	0	0	0	0
Priority Unfunded	0	0	0	0	0	0	0
Total Costs:	\$744,294	\$8,528,898	\$0	\$0	\$0	\$0	\$9,273,192

Impact On Operations: This project will increase the operational budget for maintenance of the new bridge deck.

Project Location:
I-5 and Magic Mountain Interchange.

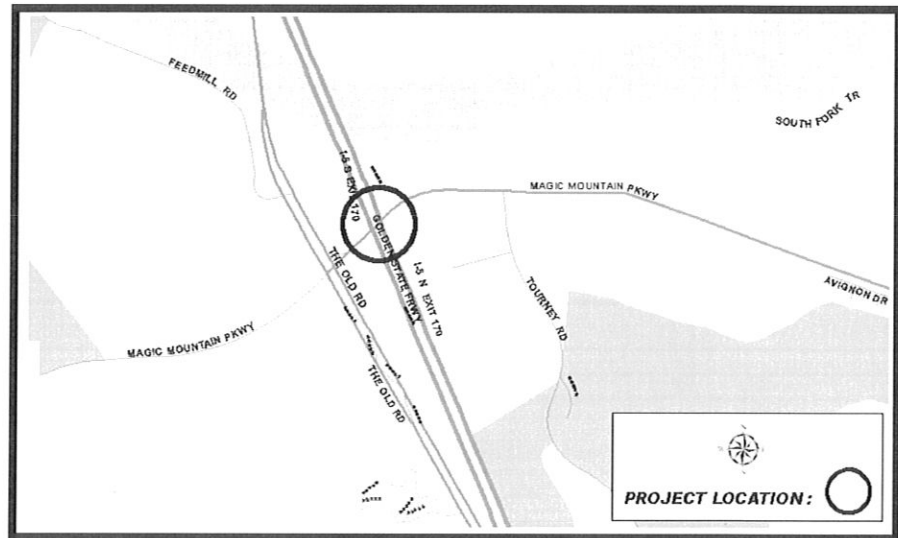

Description: The Phase II effort provided for City oversight of The Old Road and Magic Mountain Parkway. This is a joint effort between the City and the Los Angeles County Department of Public Works and Caltrans. The current funding will fund final closeout.

Justification: This funding will provide for final construction costs of the roadway per the City/County Cooperative Agreement.

Project Status: In progress.

Department: Public Works

Project Supervisor: Curtis Nay

Project Cost Est. (\$):

<u>Expenditure/Category:</u>	<u>PriorYears</u>	<u>2012-13</u>	<u>2013-14</u>	<u>2014-15</u>	<u>2015-16</u>	<u>2016-17</u>	<u>Total</u>
Environ/NPDES	100,000	0	0	0	0	0	100,000
Design/Plan Review	2,375,000	0	0	0	0	0	2,375,000
Right-of-Way	907,000	1,115,000	0	0	0	0	2,022,000
Construction	38,733,855	685,000	0	0	0	0	39,418,855
Inspection & Admin	2,300,745	0	0	0	0	0	2,300,745
Contingency	1,548,549	0	0	0	0	0	1,548,549
Total Costs:	\$45,965,149	\$1,800,000	\$0	\$0	\$0	\$0	\$47,765,149

Project Funding:

<u>Funding Source:</u>	<u>PriorYears</u>	<u>2012-13</u>	<u>2013-14</u>	<u>2014-15</u>	<u>2015-16</u>	<u>2016-17</u>	<u>Total</u>
B&T Valencia	30,972,573	1,434,103	0	0	0	0	32,406,676
LMD	57,443	0	0	0	0	0	57,443
Prop. C Grant	14,935,133	365,897	0	0	0	0	15,301,030
	0	0	0	0	0	0	0
	0	0	0	0	0	0	0
	0	0	0	0	0	0	0
	0	0	0	0	0	0	0
Priority Unfunded	0	0	0	0	0	0	0
Total Costs:	\$45,965,149	\$1,800,000	\$0	\$0	\$0	\$0	\$47,765,149

Impact On Operations: None.

LOST CANYON ROAD BRIDGE WIDENING

Project Number: S3029

Project Location:
Lost Canyon Road at
the Santa Clara River.

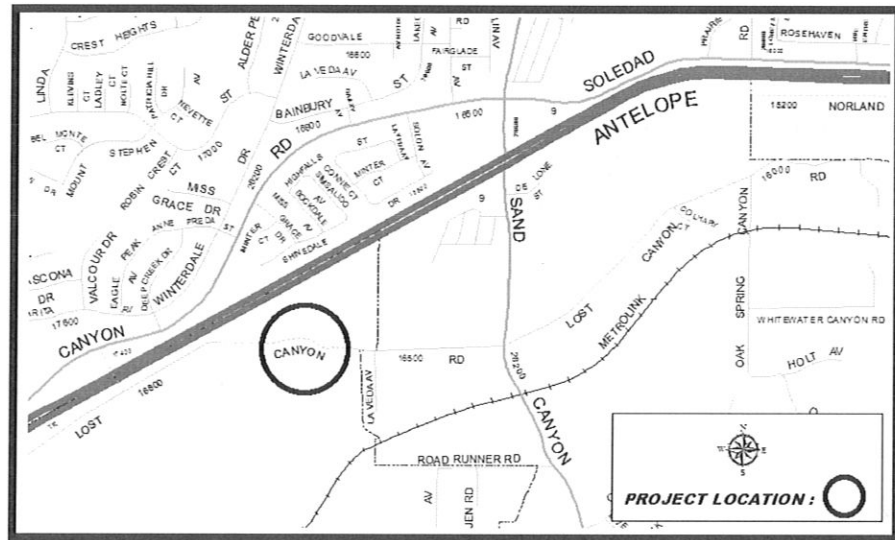

Description: This project will design and construct bridge widening improvements that will accommodate two 12-foot-wide travel lanes, 4-foot-wide shoulders, and a multi-use path on the northern side of the bridge.

Justification: The existing bridge is functionally obsolete. The deck is too narrow for the amount of traffic it carries. Widening the bridge to current standards would remove the FO status and improve circulation and pedestrian travel.

Project Status: In progress. **Department:** Public Works **Project Supervisor:** Curtis Nay

Project Cost Est. (\$):

<u>Expenditure/Category:</u>	<u>Prior Years</u>	<u>2012-13</u>	<u>2013-14</u>	<u>2014-15</u>	<u>2015-16</u>	<u>2016-17</u>	<u>Total</u>
Environ/NPDES	0	6,292	0	0	0	0	6,292
Design/Plan Review	200,000	0	0	0	0	0	200,000
Right-of-Way	0	0	0	0	0	0	0
Construction	0	580,000	300,000	0	0	0	880,000
Inspection & Admin	0	55,000	0	0	0	0	55,000
Contingency	0	60,000	0	0	0	0	60,000
Total Costs:	\$200,000	\$701,292	\$300,000	\$0	\$0	\$0	\$1,201,292

Project Funding:

<u>Funding Source:</u>	<u>Prior Years</u>	<u>2012-13</u>	<u>2013-14</u>	<u>2014-15</u>	<u>2015-16</u>	<u>2016-17</u>	<u>Total</u>
Federal HBP Grant	177,060	584,298	0	0	0	0	761,358
TDA Article 3	22,940	2,294	0	0	0	0	25,234
TDA Article 8	0	114,700	0	0	0	0	114,700
	0	0	0	0	0	0	0
	0	0	0	0	0	0	0
	0	0	0	0	0	0	0
	0	0	0	0	0	0	0
Priority Unfunded	0	0	300,000	0	0	0	300,000
Total Costs:	\$200,000	\$701,292	\$300,000	\$0	\$0	\$0	\$1,201,292

Impact On Operations: None.

Project Location:
McBean Parkway at the
Santa Clara River Trail.

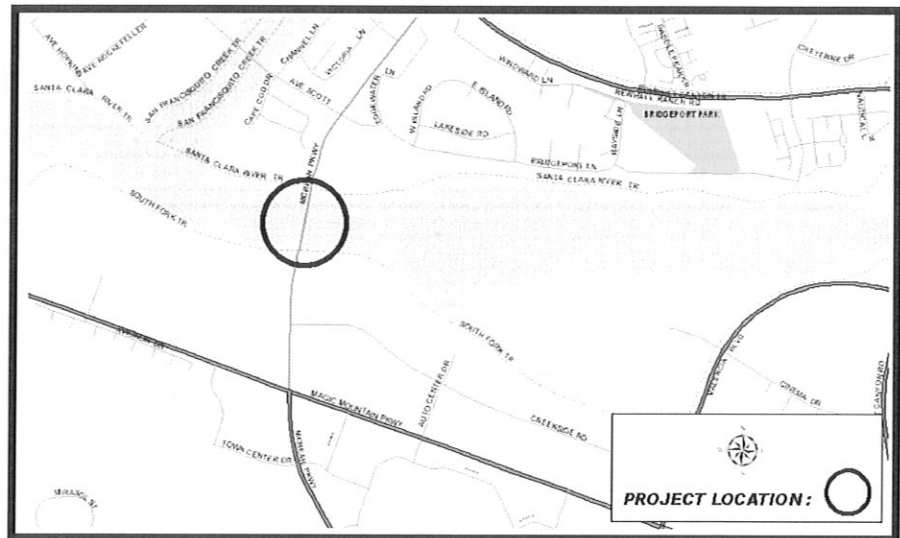

Description: This project will widen the McBean Parkway Bridge over the Santa Clara River to eight lanes and construct a Class I bike path connecting McBean Parkway and the Santa Clara River Trail, creating a multi-modal corridor. The effort will also construct a landscaped median from Avenue Scott to Magic Mountain Parkway.

Justification: Widening of the roadway and construction of the bicycle path to connect to the Santa Clara River Trail are consistent with the City's Circulation Plan and the Non-Motorized Transportation Plan. By widening the bridge to accommodate the bicycle path, the City encourages the use of non-motorized transportation for both recreational and commuter purposes.

Project Status: In progress. **Department:** Public Works **Project Supervisor:** Curtis Nay

Project Cost Est. (\$):

<u>Expenditure/Category:</u>	<u>PriorYears</u>	<u>2012-13</u>	<u>2013-14</u>	<u>2014-15</u>	<u>2015-16</u>	<u>2016-17</u>	<u>Total</u>
Environ/NPDES	0	10,000	0	0	0	0	10,000
Design/Plan Review	984,320	0	0	0	0	0	984,320
Right-of-Way	0	0	0	0	0	0	0
Construction	0	7,265,028	0	0	0	0	7,265,028
Inspection & Admin	94,569	350,000	0	0	0	0	444,569
Contingency	0	700,000	0	0	0	0	700,000
Total Costs:	\$1,078,889	\$8,325,028	\$0	\$0	\$0	\$0	\$9,403,917

Project Funding:

<u>Funding Source:</u>	<u>PriorYears</u>	<u>2012-13</u>	<u>2013-14</u>	<u>2014-15</u>	<u>2015-16</u>	<u>2016-17</u>	<u>Total</u>
B&T - Valencia	993,242	3,650,000	0	0	0	0	4,643,242
LMD 2008-1	0	200,000	0	0	0	0	200,000
Prop. C Grant	0	3,775,028	0	0	0	0	3,775,028
TDA Article 3	85,647	0	0	0	0	0	85,647
TDA Article 8	0	700,000	0	0	0	0	700,000
	0	0	0	0	0	0	0
	0	0	0	0	0	0	0
Priority Unfunded	0	0	0	0	0	0	0
Total Costs:	\$1,078,889	\$8,325,028	\$0	\$0	\$0	\$0	\$9,403,917

Impact On Operations: Increase to landscape maintenance and utility costs.

NEWHALL RANCH ROAD BRIDGE WIDENING OVER SAN FRANCISQUITO CREEK - FEASIBILITY STUDY

Project Number: S1039

Project Location:
Newhall Ranch Road
Bridge at San Francisco
Creek.

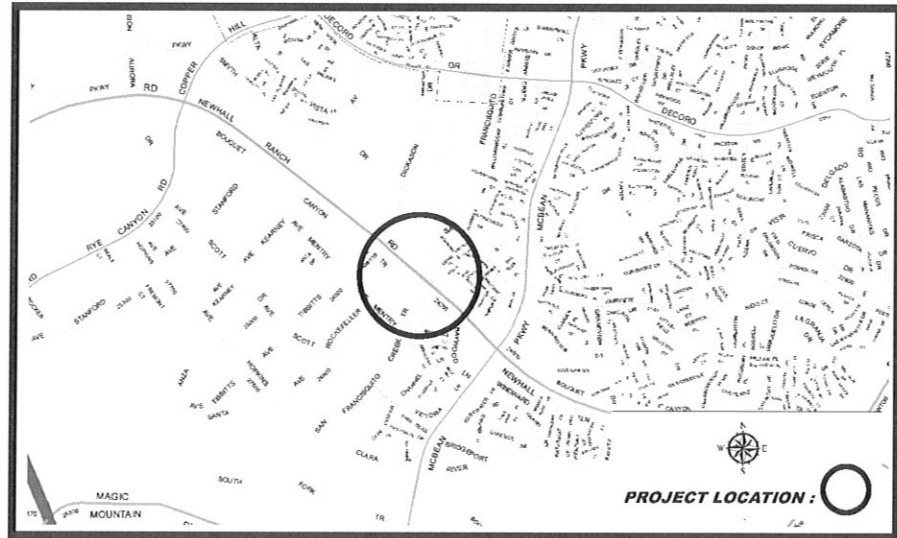

Description: This effort will conduct a feasibility study to widen the Newhall Ranch Road Bridge over the San Francisquito Creek to eight lanes and will add a multi-use path.

Justification: This area currently experiences excessive traffic backup at peak traffic hours. Widening the bridge and constructing a multi-use path for cyclists and pedestrians will allow direct access to the existing San Francisquito trail.

Project Status: Approved.

Department: Public Works

Project Supervisor: Curtis Nay

Project Cost Est. (\$):

<u>Expenditure/Category:</u>	<u>Prior Years</u>	<u>2012-13</u>	<u>2013-14</u>	<u>2014-15</u>	<u>2015-16</u>	<u>2016-17</u>	<u>Total</u>
Environ/NPDES	0	0	0	0	0	0	0
Design/Plan Review	0	20,000	0	0	0	0	20,000
Right-of-Way	0	0	0	0	0	0	0
Construction	0	0	0	0	0	0	0
Inspection & Admin	0	0	0	0	0	0	0
Contingency	0	0	0	0	0	0	0
Total Costs:	\$0	\$20,000	\$0	\$0	\$0	\$0	\$20,000

Project Funding:

<u>Funding Source:</u>	<u>Prior Years</u>	<u>2012-13</u>	<u>2013-14</u>	<u>2014-15</u>	<u>2015-16</u>	<u>2016-17</u>	<u>Total</u>
HBP Grant	0	16,000	0	0	0	0	16,000
TDA Article 8	0	4,000	0	0	0	0	4,000
	0	0	0	0	0	0	0
	0	0	0	0	0	0	0
	0	0	0	0	0	0	0
	0	0	0	0	0	0	0
	0	0	0	0	0	0	0
Priority Unfunded	0	0	0	0	0	0	0
Total Costs:	\$0	\$20,000	\$0	\$0	\$0	\$0	\$20,000

Impact On Operations: None.

VIA PRINCESSA ROAD
ISABELLA PARKWAY TO GOLDEN VALLEY ROAD

Project Number: S3026

Project Location:
The vicinity of Via Princessa Road from Isabella Parkway to Golden Valley Road.

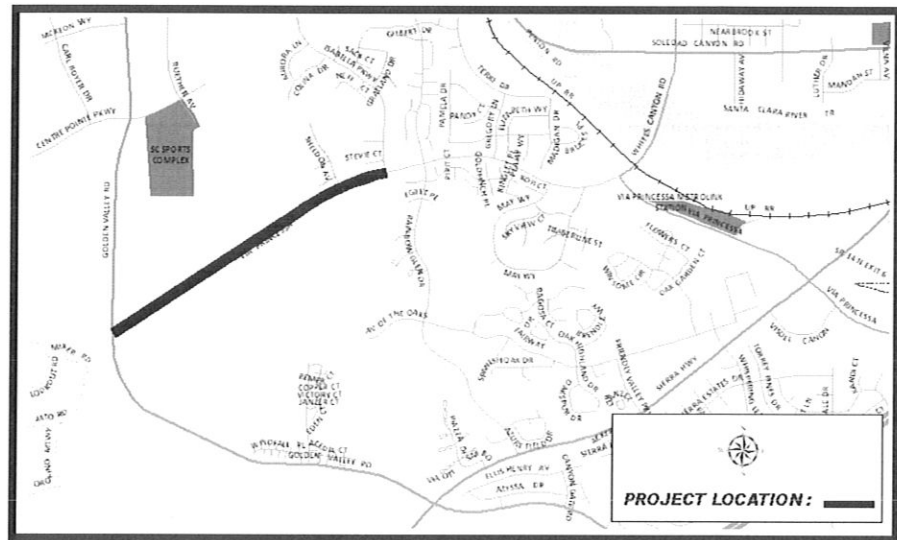

Description: This project will provide for preliminary engineering studies to extend Via Princessa Road from Isabella Parkway to Golden Valley Road. Design and construction of the roadway to occur in future years.

Justification: Construction of the roadway is consistent with the General Plan, and will improve traffic circulation in an area that will be impacted by future development.

Project Status: In progress.

Department: Public Works

Project Supervisor: Curtis Nay

Project Cost Est. (\$):

<u>Expenditure/Category:</u>	<u>PriorYears</u>	<u>2012-13</u>	<u>2013-14</u>	<u>2014-15</u>	<u>2015-16</u>	<u>2016-17</u>	<u>Total</u>
Environ/NPDES	524,550	10,450	500,000	0	0	0	1,035,000
Design/Plan Review	0	0	3,700,000	0	0	0	3,700,000
Right-of-Way	0	0	0	20,000,000	20,000,000	0	40,000,000
Construction	0	0	0	0	0	33,000,000	33,000,000
Inspection & Admin	0	0	0	0	0	1,000,000	1,000,000
Contingency	0	0	300,000	0	0	6,000,000	6,300,000
Total Costs:	\$524,550	\$10,450	\$4,500,000	\$20,000,000	\$20,000,000	\$40,000,000	\$85,035,000

Project Funding:

<u>Funding Source:</u>	<u>PriorYears</u>	<u>2012-13</u>	<u>2013-14</u>	<u>2014-15</u>	<u>2015-16</u>	<u>2016-17</u>	<u>Total</u>
B&T - East Side	524,550	10,450	0	0	0	0	535,000
Prop. C. Grant	0	0	0	2,815,000	3,727,000	5,035,000	11,577,000
	0	0	0	0	0	0	0
	0	0	0	0	0	0	0
	0	0	0	0	0	0	0
	0	0	0	0	0	0	0
	0	0	0	0	0	0	0
Priority Unfunded	0	0	4,500,000	17,185,000	16,273,000	34,965,000	72,923,000
Total Costs:	\$524,550	\$10,450	\$4,500,000	\$20,000,000	\$20,000,000	\$40,000,000	\$85,035,000

Impact On Operations: None at this time.