

**DOCKWEILER DRIVE/LYONS AVENUE - ENVIRONMENTAL**

Project Number: S3023

**Project Location:**  
Dockweiler Drive and  
Valle Del Oro to Lyons  
Avenue.

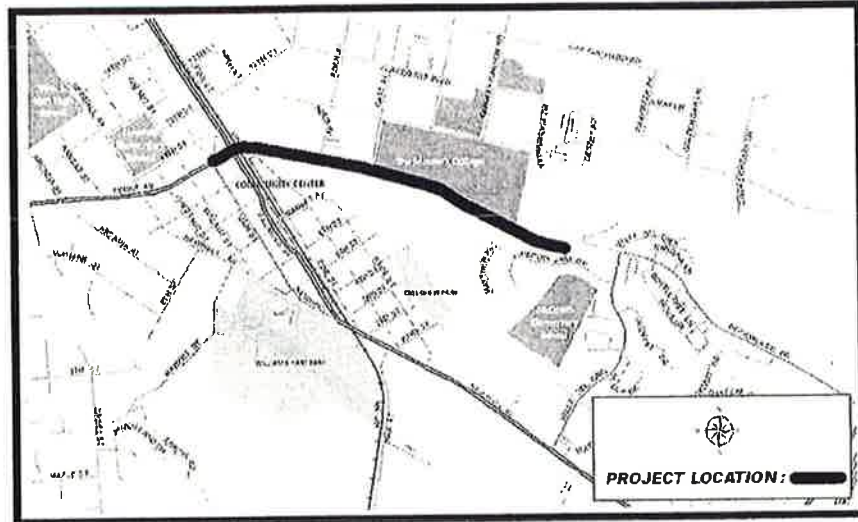

**Description:** This effort will provide for the required environmental documentation needed to proceed with design for the extension of Dockweiler Drive to Lyons Avenue.

**Justification:** Construction of the roadway is consistent with the General Plan, and will improve traffic circulation in an area that will be impacted by future development. The alignment study, conducted in a prior year, determined the necessary right-of-way for the future roadway extension.

**Project Status:** In progress.      **Department:** Public Works      **Project Supervisor:** Curtis Nay

**Project Cost Est. (\$):**

<u>Expenditure/Category:</u>	<u>PriorYears</u>	<u>2014-15</u>	<u>2015-16</u>	<u>2016-17</u>	<u>2017-18</u>	<u>2018-19</u>	<u>Total</u>
Environ/NPDES	580,356	70,000	0	0	0	1,493,393	2,143,749
Design/Plan Review	0	0	0	0	0	0	0
Right-of-Way	686,840	0	0	0	0	0	686,840
Construction	0	0	0	0	0	56,500,000	56,500,000
Inspection & Admin	0	0	0	0	0	5,500,000	5,500,000
Contingency	0	0	0	0	0	5,500,000	5,500,000
<b>Total Costs:</b>	<b>\$1,267,196</b>	<b>\$70,000</b>	<b>\$0</b>	<b>\$0</b>	<b>\$0</b>	<b>\$68,993,393</b>	<b>\$70,330,589</b>

**Project Funding:**

<u>Funding Source:</u>	<u>PriorYears</u>	<u>2014-15</u>	<u>2015-16</u>	<u>2016-17</u>	<u>2017-18</u>	<u>2018-19</u>	<u>Total</u>
B&T - Via Princessa	1,267,196	70,000	0	0	0	0	1,337,196
	0	0	0	0	0	0	0
	0	0	0	0	0	0	0
	0	0	0	0	0	0	0
	0	0	0	0	0	0	0
	0	0	0	0	0	0	0
	0	0	0	0	0	0	0
	0	0	0	0	0	0	0
Priority Unfunded	0	0	0	0	0	68,993,393	68,993,393
<b>Total Costs:</b>	<b>\$1,267,196</b>	<b>\$70,000</b>	<b>\$0</b>	<b>\$0</b>	<b>\$0</b>	<b>\$68,993,393</b>	<b>\$70,330,589</b>

**Impact On Operations:** None.

# GOLDEN VALLEY ROAD/STATE ROUTE 14 BRIDGE WIDENING

Project Number: S3028

**Project Location:**  
Golden Valley Road  
and State Route 14  
Interchange.

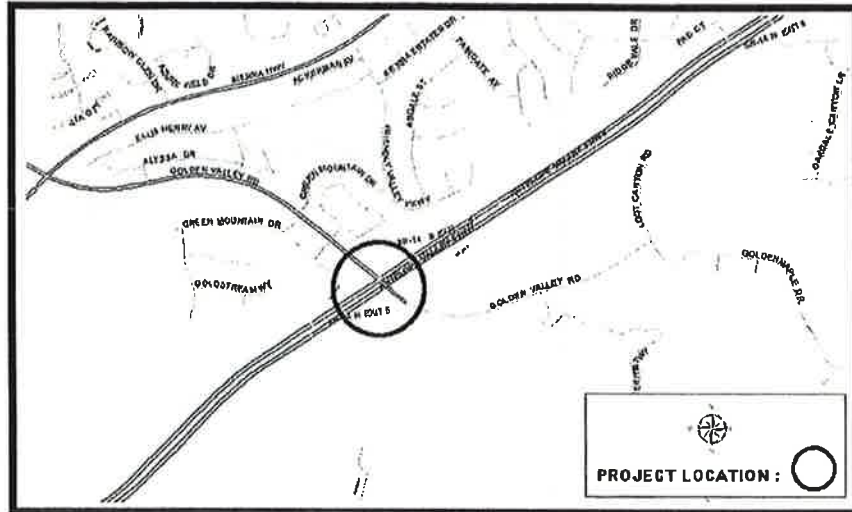

**Description:** Project will widen the bridge from the existing one lane in each direction to six total lanes. Multi-modal amenities include the construction of a sidewalk on the north side of the bridge, and a shared sidewalk and bike path on the south side. It will also make modifications to on- and off-ramps, and add landscaped medians.

**Justification:** These improvements have been identified in the Eastside Bridge and Thoroughfare District Report as necessary to accommodate anticipated increases to traffic volumes based on future development.

**Project Status:** In progress.      **Department:** Public Works      **Project Supervisor:** Curtis Nay

**Project Cost Est. (\$):**

<u>Expenditure/Category:</u>	<u>Prior Years</u>	<u>2014-15</u>	<u>2015-16</u>	<u>2016-17</u>	<u>2017-18</u>	<u>2018-19</u>	<u>Total</u>
Environ/NPDES	50,000	0	0	0	0	0	50,000
Design/Plan Review	350,000	0	0	0	0	0	350,000
Right-of-Way	0	0	0	0	0	0	0
Construction	6,500,000	0	0	0	0	0	6,500,000
Inspection & Admin	1,000,000	400,000	0	0	0	0	1,400,000
Contingency	1,147,640	0	0	0	0	0	1,147,640
<b>Total Costs:</b>	<b>\$9,047,640</b>	<b>\$400,000</b>	<b>\$0</b>	<b>\$0</b>	<b>\$0</b>	<b>\$0</b>	<b>\$9,447,640</b>

**Project Funding:**

<u>Funding Source:</u>	<u>Prior Years</u>	<u>2014-15</u>	<u>2015-16</u>	<u>2016-17</u>	<u>2017-18</u>	<u>2018-19</u>	<u>Total</u>
B&T - Eastside	4,858,801	0	0	0	0	0	4,858,801
LMD Zone 2008-1	34,303	115,697	0	0	0	0	150,000
Prop. C Grant	4,154,536	284,303	0	0	0	0	4,438,839
	0	0	0	0	0	0	0
	0	0	0	0	0	0	0
	0	0	0	0	0	0	0
	0	0	0	0	0	0	0
Priority Unfunded	0	0	0	0	0	0	0
<b>Total Costs:</b>	<b>\$9,047,640</b>	<b>\$400,000</b>	<b>\$0</b>	<b>\$0</b>	<b>\$0</b>	<b>\$0</b>	<b>\$9,447,640</b>

**Impact On Operations:** Anticipate increase to electrical utility accounts upon construction.

I-5/MAGIC MOUNTAIN PARKWAY INTERCHANGE PHASE II

Project Number: S1003

**Project Location:**  
Interstate 5 and Magic Mountain Parkway.

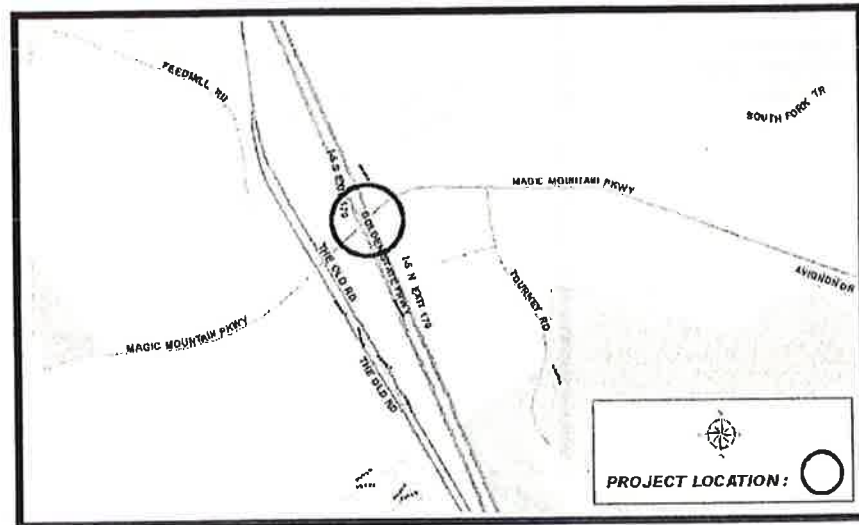

**Description:** The Phase II effort provided for City of Santa Clarita (City) oversight of the interchange improvements at The Old Road and Magic Mountain Parkway. This was a joint effort between the City and the Los Angeles County (County) Department of Public Works and Caltrans to widen and improve the interchange and surrounding area in anticipation of future development.

**Justification:** Prior year efforts constructed the improvements. This funding will provide for associated construction costs of the roadway per the City/County Cooperative Agreement.

**Project Status:** In progress.      **Department:** Public Works      **Project Supervisor:** Curtis Nay

**Project Cost Est. (\$):**

<u>Expenditure/Category:</u>	<u>Prior Years</u>	<u>2014-15</u>	<u>2015-16</u>	<u>2016-17</u>	<u>2017-18</u>	<u>2018-19</u>	<u>Total</u>
Environ/NPDES	200,000	0	0	0	0	0	200,000
Design/Plan Review	3,750,000	0	0	0	0	0	3,750,000
Right-of-Way	1,250,000	1,654,400	0	0	0	0	2,904,400
Construction	39,651,770	0	0	0	0	0	39,651,770
Inspection & Admin	925,000	0	0	0	0	0	925,000
Contingency	0	0	0	0	0	0	0
<b>Total Costs:</b>	<b>\$45,776,770</b>	<b>\$1,654,400</b>	<b>\$0</b>	<b>\$0</b>	<b>\$0</b>	<b>\$0</b>	<b>\$47,431,170</b>

**Project Funding:**

<u>Funding Source:</u>	<u>Prior Years</u>	<u>2014-15</u>	<u>2015-16</u>	<u>2016-17</u>	<u>2017-18</u>	<u>2018-19</u>	<u>Total</u>
B&T - Valencia	30,851,159	1,367,421	0	0	0	0	32,218,580
LMD Zone 18	57,443	0	0	0	0	0	57,443
Prop. C Grant	14,868,168	286,979	0	0	0	0	15,155,147
	0	0	0	0	0	0	0
	0	0	0	0	0	0	0
	0	0	0	0	0	0	0
	0	0	0	0	0	0	0
Priority Unfunded	0	0	0	0	0	0	0
<b>Total Costs:</b>	<b>\$45,776,770</b>	<b>\$1,654,400</b>	<b>\$0</b>	<b>\$0</b>	<b>\$0</b>	<b>\$0</b>	<b>\$47,431,170</b>

**Impact On Operations:** None.

**JOHN RUSSEL - PASEO BRIDGE REPLACEMENT PROGRAM** Project Number: S1042

**Project Location:**  
John Russel Drive  
between Cortina Drive  
and Via Candice.

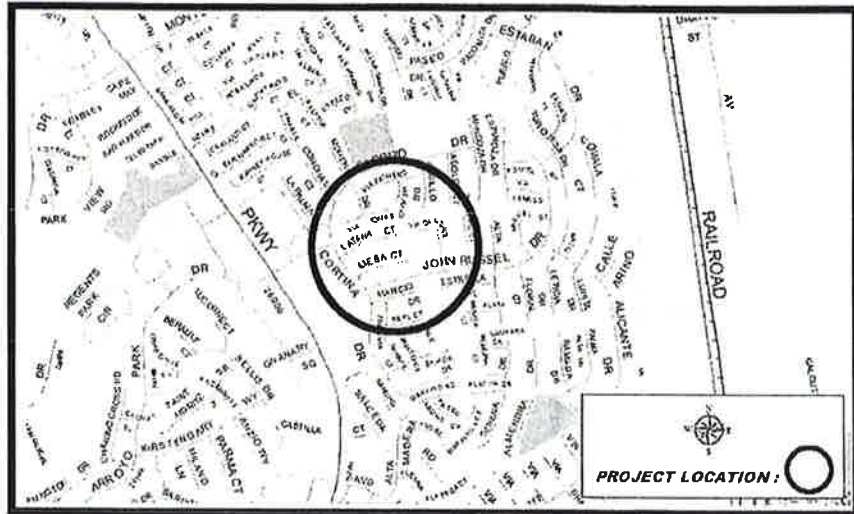

**Description:** The Paseo Bridge Replacement Program replaces pedestrian bridges in the south Valencia paseo system that have reached their useful life. This program will replace the existing wooden pedestrian bridge crossing at John Russel Drive with a steel truss bridge.

**Justification:** This bridge has reached its useful life and has been identified as in need of replacement rather than repair. Replacing the wooden structure with a steel structure is more cost effective when factored against the high cost of maintaining a wooden structure for its expected life span.

**Project Status:** Approved,      **Department:** Public Works      **Project Supervisor:** Curtis Nay

**Project Cost Est. (\$):**

<u>Expenditure/Category:</u>	<u>PriorYears</u>	<u>2014-15</u>	<u>2015-16</u>	<u>2016-17</u>	<u>2017-18</u>	<u>2018-19</u>	<u>Total</u>
Environ/NPDES	0	0	0	0	0	0	0
Design/Plan Review	0	50,000	0	0	0	0	50,000
Right-of-Way	0	0	0	0	0	0	0
Construction	0	450,000	0	0	0	0	450,000
Inspection & Admin	0	45,000	0	0	0	0	45,000
Contingency	0	0	0	0	0	0	0
<b>Total Costs:</b>	<b>\$0</b>	<b>\$545,000</b>	<b>\$0</b>	<b>\$0</b>	<b>\$0</b>	<b>\$0</b>	<b>\$545,000</b>

**Project Funding:**

<u>Funding Source:</u>	<u>PriorYears</u>	<u>2014-15</u>	<u>2015-16</u>	<u>2016-17</u>	<u>2017-18</u>	<u>2018-19</u>	<u>Total</u>
LMD Zone T-7	0	545,000	0	0	0	0	545,000
	0	0	0	0	0	0	0
	0	0	0	0	0	0	0
	0	0	0	0	0	0	0
	0	0	0	0	0	0	0
	0	0	0	0	0	0	0
	0	0	0	0	0	0	0
Priority Unfunded	0	0	0	0	0	0	0
<b>Total Costs:</b>	<b>\$0</b>	<b>\$545,000</b>	<b>\$0</b>	<b>\$0</b>	<b>\$0</b>	<b>\$0</b>	<b>\$545,000</b>

**Impact On Operations:** None.

# LOST CANYON ROAD BRIDGE WIDENING

Project Number: S3029

**Project Location:**  
Lost Canyon Road at  
the Santa Clara River.

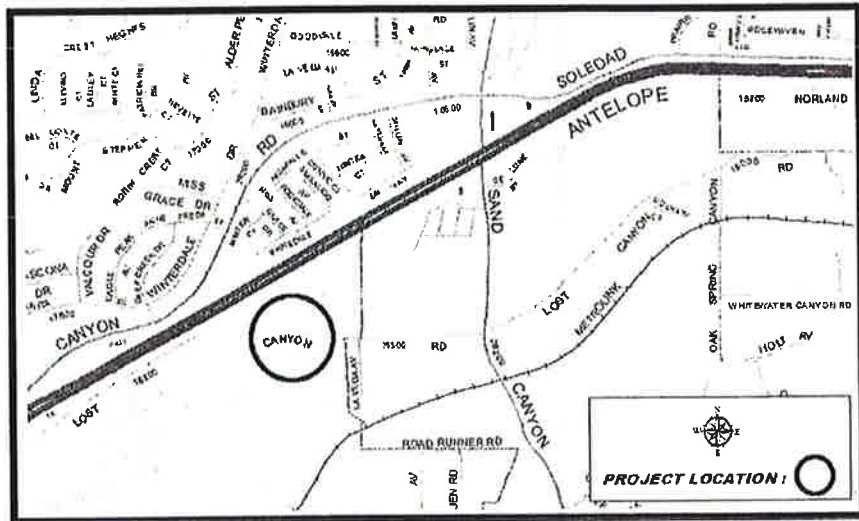

**Description:** This project will design and construct bridge widening improvements that will accommodate two 12-foot-wide travel lanes, 4-foot-wide shoulders, and a multi-use path on the north side of the bridge.

**Justification:** The existing bridge is functionally obsolete (FO). The deck is too narrow for the amount of traffic it carries. Widening the bridge to current standards would remove the FO status and improve circulation and pedestrian travel.

**Project Status:** In progress.      **Department:** Public Works      **Project Supervisor:** Curtis Nay

**Project Cost Est. (\$):**

<u>Expenditure/Category:</u>	<u>PriorYears</u>	<u>2014-15</u>	<u>2015-16</u>	<u>2016-17</u>	<u>2017-18</u>	<u>2018-19</u>	<u>Total</u>
Environ/NPDES	0	7,500	0	0	0	0	7,500
Design/Plan Review	300,000	0	0	0	0	0	300,000
Right-of-Way	0	0	0	0	0	0	0
Construction	0	1,000,000	0	0	0	0	1,000,000
Inspection & Admin	26,796	87,090	0	0	0	0	113,886
Contingency	0	100,000	0	0	0	0	100,000
<b>Total Costs:</b>	<b>\$326,796</b>	<b>\$1,194,590</b>	<b>\$0</b>	<b>\$0</b>	<b>\$0</b>	<b>\$0</b>	<b>\$1,521,386</b>

**Project Funding:**

<u>Funding Source:</u>	<u>PriorYears</u>	<u>2014-15</u>	<u>2015-16</u>	<u>2016-17</u>	<u>2017-18</u>	<u>2018-19</u>	<u>Total</u>
Federal HBP Grant	297,357	1,041,330	0	0	0	0	1,338,687
Gas Tax	15,217	23,956	0	0	0	0	39,173
TDA Article 3	4,222	0	0	0	0	0	4,222
TDA Article 8	10,000	129,304	0	0	0	0	139,304
	0	0	0	0	0	0	0
	0	0	0	0	0	0	0
	0	0	0	0	0	0	0
Priority Unfunded	0	0	0	0	0	0	0
<b>Total Costs:</b>	<b>\$326,796</b>	<b>\$1,194,590</b>	<b>\$0</b>	<b>\$0</b>	<b>\$0</b>	<b>\$0</b>	<b>\$1,521,386</b>

**Impact On Operations:** None.

**MCBEAN PARKWAY BRIDGE WIDENING OVER THE RIVER**

Project Number: S1037

**Project Location:**  
McBean Parkway at the  
Santa Clara River Trail.

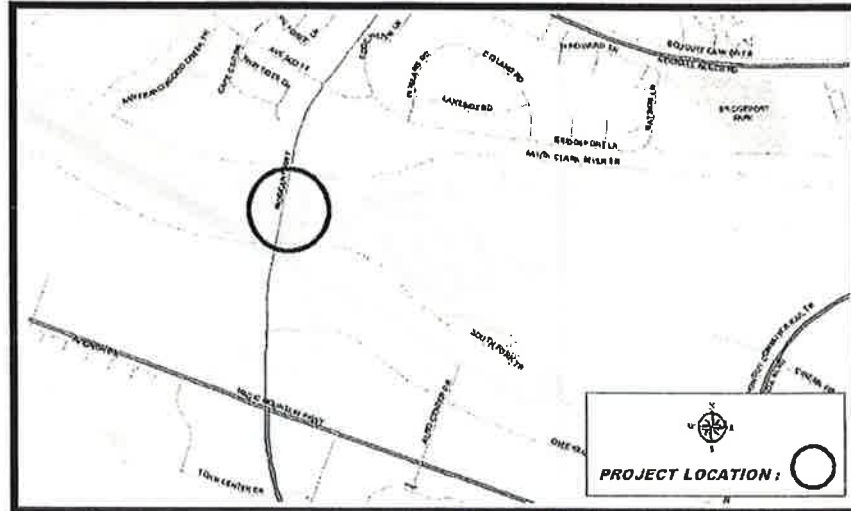

**Description:** This project will widen the McBean Parkway Bridge over the Santa Clara River to eight lanes and construct a Class I bike path connecting McBean Parkway and the Santa Clara River Trail, creating a multi-modal corridor. The effort will also construct a landscaped median from Avenue Scott to Magic Mountain Parkway.

**Justification:** Widening of the roadway and construction of the bicycle path to connect to the Santa Clara River Trail are consistent with the City of Santa Clarita's (City) Circulation Plan and the Non-Motorized Transportation Plan. By widening the bridge to accommodate the bicycle path, the City encourages the use of non-motorized transportation for both recreational and commuter purposes.

**Project Status:** In progress.      **Department:** Public Works      **Project Supervisor:** Curtis Nay

**Project Cost Est. (\$):**

<u>Expenditure/Category:</u>	<u>Prior Years</u>	<u>2014-15</u>	<u>2015-16</u>	<u>2016-17</u>	<u>2017-18</u>	<u>2018-19</u>	<u>Total</u>
Environ/NPDES	82,235	0	0	0	0	0	82,235
Design/Plan Review	1,000,000	0	0	0	0	0	1,000,000
Right-of-Way	0	0	0	0	0	0	0
Construction	7,351,857	0	0	0	0	0	7,351,857
Inspection & Admin	1,153,426	50,000	0	0	0	0	1,203,426
Contingency	1,009,300	0	0	0	0	0	1,009,300
<b>Total Costs:</b>	<b>\$10,596,818</b>	<b>\$50,000</b>	<b>\$0</b>	<b>\$0</b>	<b>\$0</b>	<b>\$0</b>	<b>\$10,646,818</b>

**Project Funding:**

<u>Funding Source:</u>	<u>Prior Years</u>	<u>2014-15</u>	<u>2015-16</u>	<u>2016-17</u>	<u>2017-18</u>	<u>2018-19</u>	<u>Total</u>
B&T - Valencia	4,593,242	50,000	0	0	0	0	4,643,242
General Fund Capital	78,500	0	0	0	0	0	78,500
LMD Zone 2008-1	424,063	0	0	0	0	0	424,063
Prop. C Grant	3,984,003	0	0	0	0	0	3,984,003
TDA Article 3	85,647	0	0	0	0	0	85,647
TDA Article 8	1,431,363	0	0	0	0	0	1,431,363
	0	0	0	0	0	0	0
Priority Unfunded	0	0	0	0	0	0	0
<b>Total Costs:</b>	<b>\$10,596,818</b>	<b>\$50,000</b>	<b>\$0</b>	<b>\$0</b>	<b>\$0</b>	<b>\$0</b>	<b>\$10,646,818</b>

**Impact On Operations:** Increase to landscape maintenance and utility costs.

# NEWHALL RANCH ROAD BRIDGE WIDENING OVER SAN FRANCISQUITO CREEK

Project Number: S1039

**Project Location:**  
Newhall Ranch Road  
Bridge at San  
Francisquito Creek.

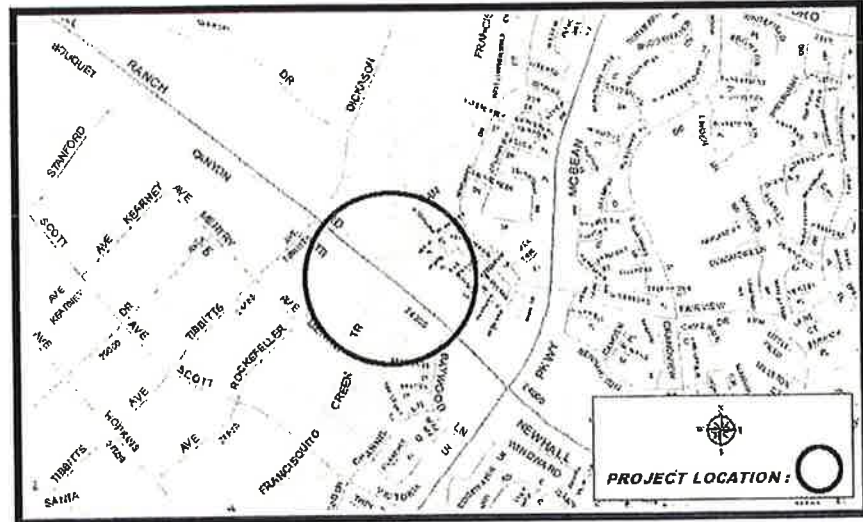

**Description:** This effort will design the widening of the Newhall Ranch Road bridge over the San Francisquito Creek to eight lanes. Scope will also include the design of a multi-use path. Construction would occur in a future year.

**Justification:** This area currently experiences excessive traffic backup at peak hours. Widening the bridge and constructing a multi-use path for cyclists and pedestrians will allow direct access to the existing San Francisquito trail.

**Project Status:** In progress.      **Department:** Public Works      **Project Supervisor:** Curtis Nay

**Project Cost Est. (\$):**

<u>Expenditure/Category:</u>	<u>PriorYears</u>	<u>2014-15</u>	<u>2015-16</u>	<u>2016-17</u>	<u>2017-18</u>	<u>2018-19</u>	<u>Total</u>
Environ/NPDES	0	70,000	0	0	0	0	70,000
Design/Plan Review	1,445,428	342,708	0	0	0	0	1,788,136
Right-of-Way	0	70,000	0	0	0	0	70,000
Construction	0	0	0	0	0	0	0
Inspection & Admin	0	137,915	0	0	0	0	137,915
Contingency	0	68,950	0	0	0	0	68,950
<b>Total Costs:</b>	<b>\$1,445,428</b>	<b>\$689,573</b>	<b>\$0</b>	<b>\$0</b>	<b>\$0</b>	<b>\$0</b>	<b>\$2,135,001</b>

**Project Funding:**

<u>Funding Source:</u>	<u>PriorYears</u>	<u>2014-15</u>	<u>2015-16</u>	<u>2016-17</u>	<u>2017-18</u>	<u>2018-19</u>	<u>Total</u>
Gas Tax	156,287	86,304	0	0	0	0	242,591
Federal HBP Grant	1,286,885	603,269	0	0	0	0	1,890,154
TDA Article 8	2,256	0	0	0	0	0	2,256
	0	0	0	0	0	0	0
	0	0	0	0	0	0	0
	0	0	0	0	0	0	0
	0	0	0	0	0	0	0
Priority Unfunded	0	0	0	0	0	0	0
<b>Total Costs:</b>	<b>\$1,445,428</b>	<b>\$689,573</b>	<b>\$0</b>	<b>\$0</b>	<b>\$0</b>	<b>\$0</b>	<b>\$2,135,001</b>

**Impact On Operations:** None at this time.

**SAND CANYON ROAD AND VIA PRINCESSA GUARDRAILS**

**Project Number: S3034**

**Project Location:**  
 Sand Canyon Road in the vicinity of Alamo Canyon Drive, and Via Princessa at Whites Canyon Road.

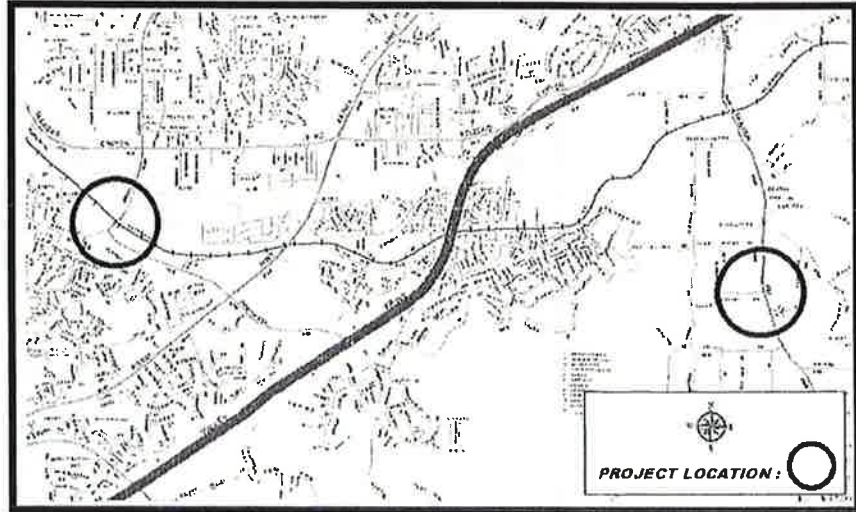

**Description:** Project will construct guardrails on Sand Canyon Road and on Via Princessa. Sand Canyon Road location effort will construct 100 feet of guardrail on the east side of the roadway, and relocate a utility pole. Pavement and striping work on the roadway will need to be shifted to the west to accommodate the guardrail. Via Princessa location effort will construct 450 feet of guardrail on the south side and 150 feet of guardrail on the north side of the street to join into existing guardrails. Slope mitigation will also be required to properly construct the improvements.

**Justification:** These two locations have been identified as in need of mitigation to promote roadway safety and circulation. City of Santa Clarita staff has successfully petitioned for grant funds to construct the improvements.

**Project Status:** Approved.      **Department:** Public Works      **Project Supervisor:** Andrew Yi

**Project Cost Est. (\$):**

<u>Expenditure/Category:</u>	<u>PriorYears</u>	<u>2014-15</u>	<u>2015-16</u>	<u>2016-17</u>	<u>2017-18</u>	<u>2018-19</u>	<u>Total</u>
Environ/NPDES	0	1,000	0	0	0	0	1,000
Design/Plan Review	0	35,000	0	0	0	0	35,000
Right-of-Way	0	0	0	0	0	0	0
Construction	0	175,490	0	0	0	0	175,490
Inspection & Admin	0	30,000	0	0	0	0	30,000
Contingency	0	26,310	0	0	0	0	26,310
<b>Total Costs:</b>	<b>\$0</b>	<b>\$267,800</b>	<b>\$0</b>	<b>\$0</b>	<b>\$0</b>	<b>\$0</b>	<b>\$267,800</b>

**Project Funding:**

<u>Funding Source:</u>	<u>PriorYears</u>	<u>2014-15</u>	<u>2015-16</u>	<u>2016-17</u>	<u>2017-18</u>	<u>2018-19</u>	<u>Total</u>
Federal HSIP Grant	0	208,600	0	0	0	0	208,600
TDA Article 8	0	59,200	0	0	0	0	59,200
	0	0	0	0	0	0	0
	0	0	0	0	0	0	0
	0	0	0	0	0	0	0
	0	0	0	0	0	0	0
	0	0	0	0	0	0	0
Priority Unfunded	0	0	0	0	0	0	0
<b>Total Costs:</b>	<b>\$0</b>	<b>\$267,800</b>	<b>\$0</b>	<b>\$0</b>	<b>\$0</b>	<b>\$0</b>	<b>\$267,800</b>

**Impact On Operations:** None.



**SIERRA HIGHWAY BRIDGES  
OVER THE SANTA CLARA RIVER**

Project Number: S3030

**Project Location:**  
Sierra Highway at the  
Santa Clara River

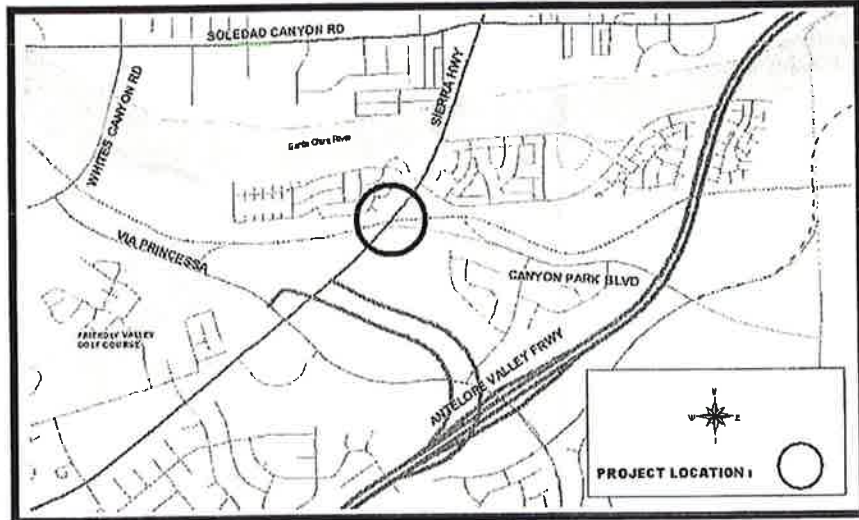

**Description:** This effort will complete design for the eventual widening of the northbound bridge and replacement the southbound bridge to eliminate its classification of structurally deficient and functionally obsolete. Both bridges will be constructed to accommodate a 44-foot travel width, with additional shoulders and sidewalk.

**Justification:** The bridges over the river do not adequately provide for motorist and pedestrian needs, and replacement of the southbound bridge is necessary to address its "functionally obsolete" classification. The widening and replacement effort is a joint County/City endeavor, with the County completing the final design effort with the City, and the City overseeing future construction. Current year effort will complete the design via LA County work order; and provide for land survey activities, resolve utility issues and right of way needs, and complete environmental requirements and permits, and obtain any necessary easements and right-of-way

**Project Status:** In progress.      **Department:** Public Works      **Project Supervisor:** Curtis Nay

**Project Cost Est. (\$):**

<u>Expenditure/Category:</u>	<u>PriorYears</u>	<u>2014-15</u>	<u>2015-16</u>	<u>2016-17</u>	<u>2017-18</u>	<u>2018-19</u>	<u>Total</u>
Environ/NPDES	0	0	10,000	0	0	0	10,000
Design/Plan Review	125,000	200,537	0	0	0	0	325,537
Right-of-Way	0	225,000	0	0	0	0	225,000
Construction	0	0	4,700,000	0	0	0	4,700,000
Inspection & Admin	18,940	50,000	522,000	0	0	0	590,940
Contingency	0	0	620,099	0	0	0	620,099
<b>Total Costs:</b>	<b>\$143,940</b>	<b>\$475,537</b>	<b>\$5,852,099</b>	<b>\$0</b>	<b>\$0</b>	<b>\$0</b>	<b>\$6,471,576</b>

**Project Funding:**

<u>Funding Source:</u>	<u>PriorYears</u>	<u>2014-15</u>	<u>2015-16</u>	<u>2016-17</u>	<u>2017-18</u>	<u>2018-19</u>	<u>Total</u>
B&T Eastside	126,000	24,000	0	0	0	0	150,000
Federal HBP Grant	0	196,537	0	0	0	0	196,537
Gas Tax	17,940	55,000	0	0	0	0	72,940
TDA Article 8	0	200,000	0	0	0	0	200,000
	0	0	0	0	0	0	0
	0	0	0	0	0	0	0
	0	0	0	0	0	0	0
Priority Unfunded	0	0	5,852,099	0	0	0	5,852,099
<b>Total Costs:</b>	<b>\$143,940</b>	<b>\$475,537</b>	<b>\$5,852,099</b>	<b>\$0</b>	<b>\$0</b>	<b>\$0</b>	<b>\$6,471,576</b>

**Impact On Operations:** None at this time.

**SIERRA HIGHWAY/GOLDEN VALLEY ROAD  
PEDESTRIAN BRIDGE AND ROADWAY IMPROVEMENTS**

Project Number: S3031

**Project Location:**  
Sierra Highway and  
Golden Valley Road.

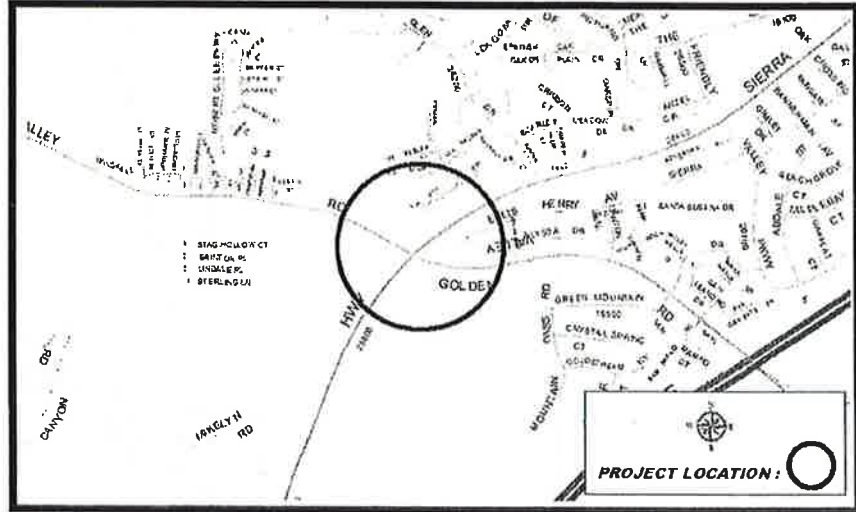

**Description:** Effort will construct a pedestrian overcrossing at Sierra Highway, a right-hand turnpocket from southbound Sierra Highway to westbound Golden Valley Road, median extension and landscaping. Effort will also provide for a bus shelter and bus pad and signal modifications at the intersections of Rainbow Glen and Golden Valley Road; and Sierra Highway and Golden Valley Road.

**Justification:** Construction of the pedestrian bridge will provide a designated passageway across this major arterial. The roadway improvements will improve traffic circulation in this heavily traveled intersection. Additionally, the landscape improvements will promote the City of Santa Clarita's (City) commitment to beautification of its major corridors.

**Project Status:** In progress.      **Department:** Public Works      **Project Supervisor:** Curtis Nay

**Project Cost Est. (\$):**

<u>Expenditure/Category:</u>	<u>PriorYears</u>	<u>2014-15</u>	<u>2015-16</u>	<u>2016-17</u>	<u>2017-18</u>	<u>2018-19</u>	<u>Total</u>
Environ/NPDES	0	0	0	0	0	0	0
Design/Plan Review	266,390	0	0	0	0	0	266,390
Right-of-Way	0	0	0	0	0	0	0
Construction	0	1,058,825	0	0	0	0	1,058,825
Inspection & Admin	48,122	226,880	0	0	0	0	275,002
Contingency	0	226,880	0	0	0	0	226,880
<b>Total Costs:</b>	<b>\$314,512</b>	<b>\$1,512,585</b>	<b>\$0</b>	<b>\$0</b>	<b>\$0</b>	<b>\$0</b>	<b>\$1,827,097</b>

**Project Funding:**

<u>Funding Source:</u>	<u>PriorYears</u>	<u>2014-15</u>	<u>2015-16</u>	<u>2016-17</u>	<u>2017-18</u>	<u>2018-19</u>	<u>Total</u>
Dev. Cash in Lieu	314,512	1,512,585	0	0	0	0	1,827,097
	0	0	0	0	0	0	0
	0	0	0	0	0	0	0
	0	0	0	0	0	0	0
	0	0	0	0	0	0	0
	0	0	0	0	0	0	0
	0	0	0	0	0	0	0
Priority Unfunded	0	0	0	0	0	0	0
<b>Total Costs:</b>	<b>\$314,512</b>	<b>\$1,512,585</b>	<b>\$0</b>	<b>\$0</b>	<b>\$0</b>	<b>\$0</b>	<b>\$1,827,097</b>

**Impact On Operations:** Increase to the City's Landscape Maintenance District operational budget.

**STORM DRAIN AND CULVERT UPGRADES - CITYWIDE**

**Project Number: N0002**

**Project Location:**  
Citywide.

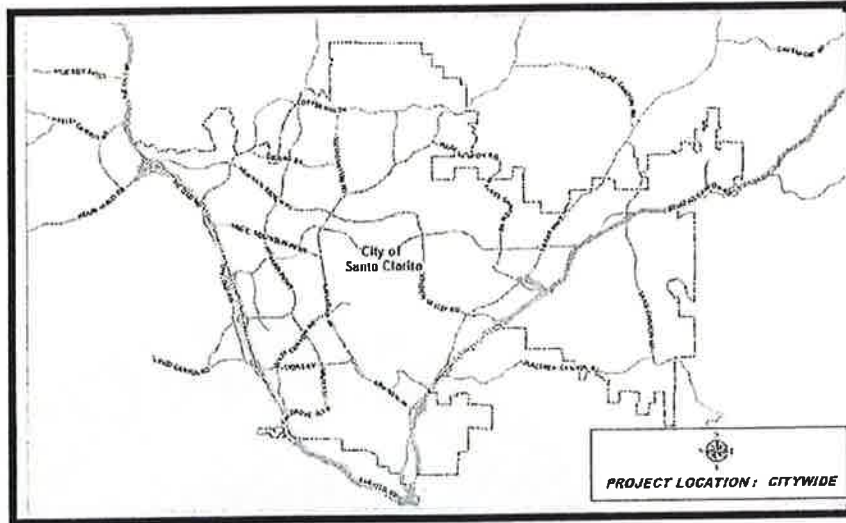

**Description:** This effort will provide for design to make upgrades and/or repairs to stormdrains and culverts. Repairs and upgrades may include the installation or replacement of improperly sized pipes and reconstruction of inlet and outlet structures. Locations include: Wiley Canyon Road, Old Wiley Canyon, 13th Street, and two sections on Sierra Highway.

**Justification:** These local roadways and intersections are experiencing asphalt damage caused by heavy floods and water ponding. By improving drainage in these identified locations, the City will prevent further damage to infrastructure, and provide improved vehicular passageways during heavy rains.

**Project Status:** In progress.      **Department:** Public Works      **Project Supervisor:** Curtis Nay

**Project Cost Est. (\$):**

<u>Expenditure/Category:</u>	<u>PriorYears</u>	<u>2014-15</u>	<u>2015-16</u>	<u>2016-17</u>	<u>2017-18</u>	<u>2018-19</u>	<u>Total</u>
Environ/NPDES	0	0	4,000	0	0	0	4,000
Design/Plan Review	92,572	100,000	0	0	0	0	192,572
Right-of-Way	0	0	0	0	0	0	0
Construction	0	0	423,505	0	0	0	423,505
Inspection & Admin	0	23,301	40,000	0	0	0	63,301
Contingency	0	0	40,000	0	0	0	40,000
<b>Total Costs:</b>	<b>\$92,572</b>	<b>\$123,301</b>	<b>\$507,505</b>	<b>\$0</b>	<b>\$0</b>	<b>\$0</b>	<b>\$723,378</b>

**Project Funding:**

<u>Funding Source:</u>	<u>PriorYears</u>	<u>2014-15</u>	<u>2015-16</u>	<u>2016-17</u>	<u>2017-18</u>	<u>2018-19</u>	<u>Total</u>
FEMA Grant	29,194	63,301	407,505	0	0	0	500,000
General Fund	23,378	0	0	0	0	0	23,378
Storm Water Utility	40,000	60,000	0	0	0	0	100,000
	0	0	0	0	0	0	0
	0	0	0	0	0	0	0
	0	0	0	0	0	0	0
	0	0	0	0	0	0	0
Priority Unfunded	0	0	100,000	0	0	0	100,000
<b>Total Costs:</b>	<b>\$92,572</b>	<b>\$123,301</b>	<b>\$507,505</b>	<b>\$0</b>	<b>\$0</b>	<b>\$0</b>	<b>\$723,378</b>

**Impact On Operations:** None.

